

INSTRUCTIONS FOR ASSEMBLING AND OPERATING YOUR GIANT-VAC

*Self-Propelled*  
*'Whisper Jet' Blower*  
MODEL 16-WJ-SP

***Congratulations!***

You have just purchased one of the finest pieces of outdoor power equipment on the market today. The Giant-Vac Self-Propelled Whisper Jet Blower represents the very latest in outdoor power equipment technology, and is indeed one of the most eagerly awaited advances in the field to date.

If properly cared for, your Giant-Vac Self-Propelled Whisper Jet Blower will provide years of dependable service. Please read and follow this instruction manual carefully in order to get the most out of your new equipment.

First, inspect machine for any damage that may have occurred in shipping. If found, IMMEDIATELY notify the transport carrier who delivered your machine, as they are responsible for the damage and are the only ones to make any adjustments.

Your Giant-Vac Self-Propelled Whisper Jet Blower requires very little assembly. Simply follow the preliminary setup routine described within this manual to begin enjoying the benefits of your new unit.

---

**CALIFORNIA PROPOSITION 65 WARNING**

**Gasoline and Diesel engine exhaust and some of its constituents are known to the State of California to cause cancer, birth defects and other reproductive harm.**

**As an owner of off-road gasoline or diesel engine equipment and/or as an employer, you also may have an obligation under the California Occupational Safety and Health Act or under Proposition 65 to warn persons exposed to gas and diesel engine exhaust and/or other Proposition 65 chemicals in and around your workplace. See California Health and Safety Code section 25249.5, Title 22 of the California Code of Regulations at Section 1200 *et seq.*, and Title 8 of the California Code of Regulations Section 5194.**

---

---

# 1

## ASSEMBLY AND PRELIMINARY SETUP

---

### **ASSEMBLY:**

Before you begin, locate and identify the following parts included in your kit (please refer to parts list for correct part identification and placement):

- 1 – Upper handle (with foam grip and drive engagement bar, Ref #60, installed) - Ref #87
- 2 – Lower handles – Ref #96
- 1 – Mid-handle support bracket – Ref #100
- 1 – Handle brace – Ref #88
- 1 – Handle brace extension bracket – Ref #92
- 1 – Intermediate engagement lever assembly – complete – Ref #s 70-75
- 1 – Upper connecting rod assembly – complete – Ref #s 66-69
- 1 – Hardware kit

### ***HANDLE ASSEMBLY***

First, slide top of each lower handle (#96) into bottom portion of upper handle (#87), aligning holes in lower handles with corresponding holes in upper handle. Slide one 5/16 x 1-3/4 hex bolt, in from the outside of the assembly, through each set of holes. Secure right side of handle assembly (when viewed from operator's perspective) with one 5/16 lockwasher and hex nut. Locate the longer end on the mid-handle support bracket (#100), and slide slotted hole of this end over bolt on left side of handle assembly, securing with one 5/16 flatwasher, lockwasher and hex nut. Do not tighten bolts yet.

Next, align holes in sides of handle brace (#88) to upper set of holes in upper handle. (Brace should be positioned on outside of upper handle.) Secure each side of brace with one 5/16 x 1-3/4 bolt, lockwasher and hex nut as outlined in previous step. Do not tighten. Locate end of handle brace extension bracket (#92) with 90 degree bend, and attach to front hole on handle brace with one 3/8 x 1" bolt, lockwasher and hex nut. (Make sure to slide bolt up through extension bracket, rather than down through brace, to allow for proper clearance with top of engine.)

Now, carefully lower entire handle assembly into installation position. Lower bottom portion of handle brace extension bracket onto 3/8 stud on top of blower housing, securing with 3/8 lockwasher and hex nut. Align holes in bottom of lower handles with corresponding holes in engine base (two holes directly beside engine on either side), drop one 5/16 x 1-3/4 bolt through each hole, then secure with lockwasher and hex nut. Align slotted hole in mid-handle support bracket with corresponding hole in top left of Transmission & idler assy mounting bracket (#20), securing with 5/16 x 3/4" self-tapping bolt and 5/16 flatwasher. Tighten all bolts securely. (Note: Do not overtighten self-tapping bolt.)

### ***ENGAGEMENT LEVER ASSEMBLY AND CONNECTION***

First, attach intermediate engagement lever assembly to transmission and idler mounting bracket by aligning holes in base of assembly with holes in top of bracket. Drop one 3/8 x 1" hex bolt,

fitted with one 3/8 flatwasher, through each hole, securing with second flatwasher, lockwasher and hex nut. Tighten both bolts securely.

Next, thread rod fitting end onto lower engagement rod (attached to transmission shifting lever) until rod extends approximately 3/4" from top of fitting. Slip fitting end into hole in right side of lever body, then secure with 3/8" fender washer and #2 bridge pin.

Now fit threaded male end of left handed ball joint (gold color) of upper engagement rod assembly into hole in top of lever, securing with 3/8 lockwasher and jam nut. Do the same with the right handed ball joint (silver), fitting it into the receiving hole in the drive engagement bar. Secure likewise with lockwasher and jam nut. (Note: The terms 'left handed' and 'right handed' refer to thread direction inside female end of ball joint. Male end on both are standard right hand thread.)

It is recommended that the unit's forward/reverse ground speed ratio be set at approximately 2:1. In other words, the unit should travel twice as fast in forward gear as it does in reverse. This is to ensure the operator's personal safety.

To achieve this ratio, loosen jam nut securing upper engagement rod within right-handed ball joint, and turn rod in appropriate direction to increase or decrease distance between front (forward) portion of drive engagement bar and grip portion of upper handle \*, until it is twice the distance from the handle as the lower (reverse) portion of the bar. (If sufficient adjustment still cannot be made, disconnect rod fitting end from intermediate engagement lever body, and turn fitting in or out, shortening or lengthening lower rod until desired bar adjustment is achieved.)

\* Turning rod into ball joints (counter-clockwise when viewed from operator's position) increases distance, thus increasing forward ground speed, turning out decreases speed).

***Assembly of your Giant-Vac Self-Propelled Whisper Jet Blower is now complete.***

## **PRELIMINARY SETUP:**

### ***ENGINE:***

You have received a complete engine manual with your machine. Be sure to read it carefully before operation. Especially note the instructions on **OILING**. ALL MACHINES ARE SHIPPED WITHOUT OIL OR GASOLINE UNLESS OTHERWISE NOTED. (If you have any difficulties with the engine, check the Yellow Pages of your phone book for the engine dealer nearest you, rather than us, as the engines are under their own manufacturer's warranty.)

### ***BATTERY:***

The battery supplied with your new Whisper Jet Blower is shipped WITHOUT ACID in order to ensure safe transport. Battery acid is readily available at any automotive supply store. After filling battery to appropriate level, make necessary battery connections.

Setup of your Giant-Vac Whisper Jet Blower is now complete. Please read on to familiarize yourself with the units operating features, as well as important safety precautions during operation.

---

## **2**

# **SAFETY AND OPERATING INSTRUCTIONS**

---

### **SAFETY TRAINING:**

#### ***IMPORTANT!* READ THE FOLLOWING SAFETY RULES CAREFULLY BEFORE OPERATING UNIT:**

- **Regard your Giant-Vac Self-Propelled Whisper Jet Blower as a piece of power equipment and teach this regard to all who will operate this unit. Never allow children or young teenagers to operate the unit.**
- **Always wear appropriate safety equipment when operating this unit. Do not operate without proper eye, ear, breathing and hand protection.**
- **Be sure you know how to stop both the unit and the engine at a MOMENT'S NOTICE. Refer to operation section of this manual, as well as engine manual.**
- **Before starting operation, clear the entire work area of all debris that could catch on or be thrown by the Whisper Jet. High velocity discharge can easily turn loose rocks and twigs into dangerous projectiles.**
- **Do not operate with any guards or component parts removed from unit.**
- **Unless there is very good artificial light, use only during daylight.**
- **Fill gasoline driven machines outdoors. Avoid spilling gasoline and DO NOT fill the engine while it is running or while you are smoking.**
- **While in operation, keep all parts of body away from intake and exhaust sections. Never insert any body part or other foreign object in any opening while the machine is running.**
- **When operating unit, keep people and pets a safe distance away. Instruct children to keep away from the area of operation at all times.**
- **Do not use unit on steep inclines where blower can tip over, roll away from or back into operator.**
- **Before making any adjustments or repairs, stop engine and remove spark plug wire.**

---

**FAILURE TO FOLLOW THESE RULES CAN RESULT IN CHRONIC HEALTH PROBLEMS, SERIOUS INJURY, OR POSSIBLY DEATH.**

---

## **OPERATION:**

### ***BEFORE STARTING ENGINE:***

- Be sure that unit is **completely** assembled.
- Be sure to check engine's **OIL AND GASOLINE**. (See engine manufacturer's Service Manual.) **NEVER** check the engine while it is running or while you are smoking. Check **ONLY** when engine is cold.
- Be sure that red fuel valve on engine is set to open position.

### ***TO START ENGINE :***

1. Set throttle control up to "full" position. If engine is cold, set choke by pulling out choke handle.
2. Turn ignition key and hold until engine starts. (If engine fails to start within a reasonable amount of time, discontinue and check engine manual for further instructions.)
3. After engine starts, move throttle control down to approximately half and turn off choke as required.

### ***TO ENGAGE DRIVE UNIT:***

Your Giant-Vac Self-Propelled Whisper Jet Blower is equipped with a rugged, state of the art hydrostatic transmission, affording the operator infinite speed control in both forward and reverse directions. Please read the following instructions in order to acquaint yourself with its controls for the safest and most beneficial operation:

#### ***To propel unit forward:***

Grasping both upper handle and *upper* portion of drive engagement bar with both hands, slowly begin squeezing engagement bar back toward handle. The unit should begin slowly moving forward. The harder the bar is squeezed back toward the handle, the more the unit will accelerate. Likewise, slowly releasing pressure on the bar will slowly decelerate the unit. For the first few minutes of operation, practice smoothly accelerating and decelerating the unit, as this will greatly prolong transmission life, as well as provide the greatest degree of enjoyment and comfort during operation.

*To engage unit in reverse:*

Grasping both upper handle and *lower* portion of drive engagement bar, slowly squeeze bar up toward handle.

**IMPORTANT: IN CASE OF EMERGENCY, SUCH AS LOSS OF CONTROL, OR POTENTIAL COLLISION, IMMEDIATELY RELEASE ENGAGEMENT BAR. THIS WILL DISENGAGE TRANSMISSION, AND UNIT WILL COME TO A FULL STOP. \***

\*Assuming unit is operating on level surface.

### ***BLOWER OPERATION:***

**CAUTION: Do not pass by or stand on the air discharge side of any leaf blower with the engine running.**

*To blow debris out toward the front of the machine:*

Open the forward air deflector door, mounted on the front of the discharge end of the blower, by pushing the control lever to the front of the machine. This feature is ideal for such things as blowing debris from a wall or fence. Adjust engine speed to increase or decrease air discharge rate. **NEVER INSERT ANY BODY PART OR OTHER FOREIGN OBJECT IN THE OPENING WHILE THE MACHINE IS RUNNING.**

*To blow debris out toward the side of the machine:*

Close the front air deflector door by pulling the control lever back toward the rear of the machine, and adjust the side air deflector, mounted on the discharge end of the blower, by means of the 5/16 x 5/8" hex bolts on either end of the deflector. This will permit you to direct the air at the angle you desire for a specific application. Adjust engine speed to increase or decrease air discharge rate. By changing the deflector angle and the engine speed, you can move debris into a neat row easily and rapidly. **NEVER INSERT ANY BODY PART OR OTHER FOREIGN OBJECT IN THIS OPENING WHILE THE MACHINE IS RUNNING.**

### ***TO SHUT ENGINE DOWN:***

Turn ignition key to off position. If unit is not to be used for a prolonged period, close fuel valve.

## GIANT-VAC WARRANTY

GIANT-VAC MFG. INCORPORATED, here-in-after called Giant-Vac, warrants each new Giant-Vac to the original, retail purchaser of the new Giant-Vac equipment, to be free from manufacturing defects in normal service for a period of one (1) year, unless it is used for rental purposes, which limits the warranty to 30 days. This warranty does not apply to engines, tires or other parts that are purchased and warranted by their manufacturer. Items such as bags, grass catchers, hoses and blades are not warranted, as these are considered expendable items. This warranty does not include equipment failures due to normal wear.

Any obligation under this warranty is expressly limited to the replacement or repair, at an authorized servicing Giant-Vac dealer, or at a point designated by us, of such parts as appear to us to have been defective. All defective parts have to be returned freight prepaid before credit will be issued.

We shall not be liable for transportation charges in connection with the replacement or repair of defective parts.

This warranty does not apply to a Giant-Vac upon which repairs or alterations have been made by others except with our prior written approval.

We shall not be liable for consequential damages or contingent liabilities for the fitness of any Giant-Vac for any particular purpose.

We make no other express, implied or statutory warranty, nor is anyone authorized to make any in our behalf.

GIANT-VAC MFG. INCORPORATED  
P.O. BOX 195  
SOUTH WINDHAM, CT. 06266  
PHONE: 860-423-7741 • FAX: 860-423-2654

---

---

# 3

## MAINTENANCE AND STORAGE

---

1. Follow **implicitly** the engine manufacturer's recommendations for maintenance.
2. Never adjust the Whisper Jet until the engine is **off** and the spark plug wire is disconnected.
3. If carburetor adjustment is necessary, stand to one side and **keep feet and hands** in the clear while making adjustments.
4. Keep engine free of accumulations of grass, leaves or excessive grease. An accumulation of these combustible materials may result in a fire.
5. Store gasoline in a **safe and approved** container in a cool dry place
6. Keep the Whisper Jet and fuel container in locked storage to prevent children from playing and/or tampering with them.
7. Do not store gasoline powered equipment or fuel containers in a basement or any closed area where heating or heat appliances or open pilot lights are present, unless the fuel is completely drained from the power equipment and the fuel containers.



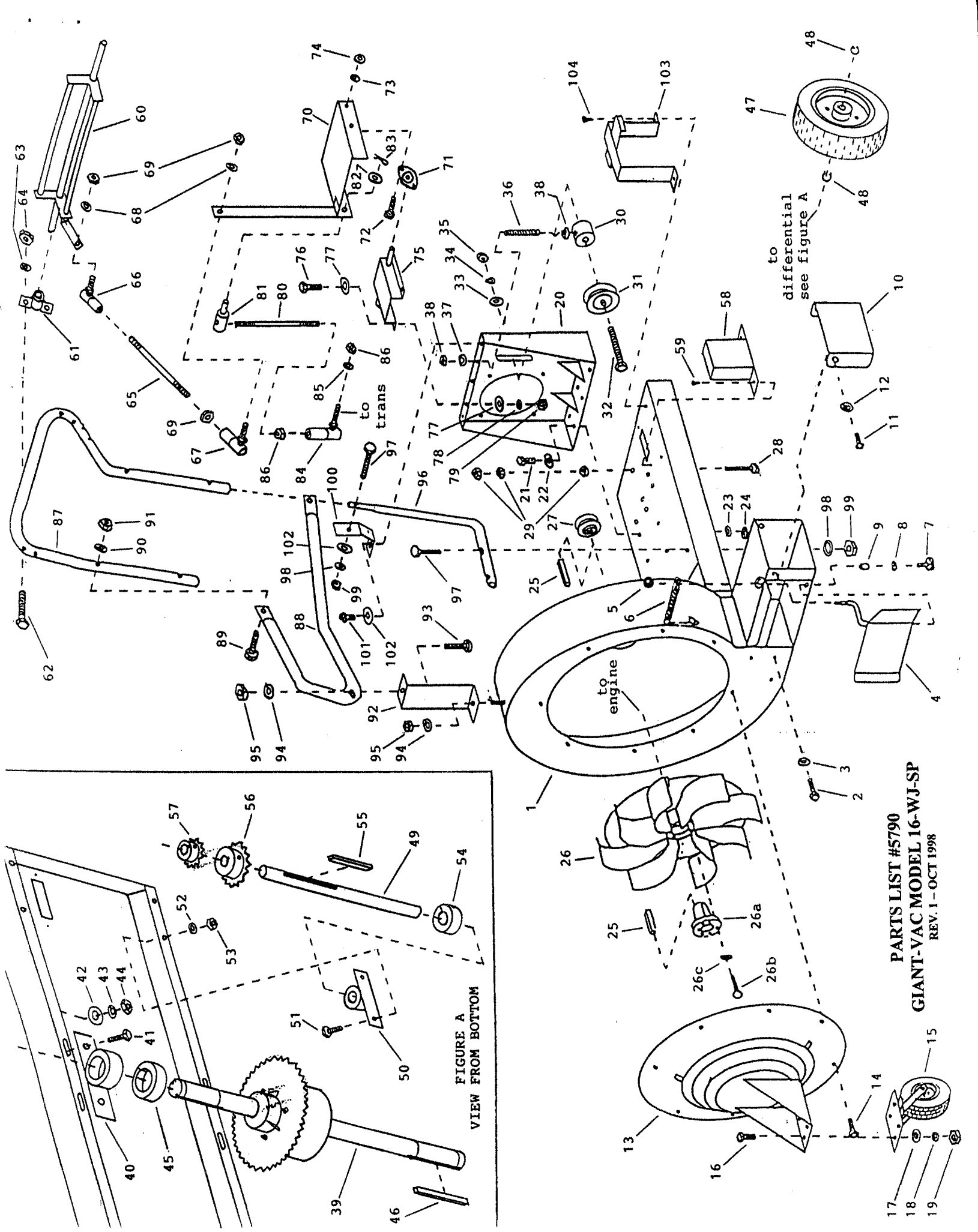

FIGURE A  
VIEW FROM BOTTOM

PARTS LIST #5790  
GIANT-VAC MODEL 16-WJ-SP  
REV. 1 - OCT 1998

to differential  
see figure A

to engine

17  
18  
19

15

47  
48  
C

48

48

48

48

48

48

48

48

48

48

48

48

48

48

48

48

48

48

48

48

48

48

48

48

48

48

48

48

**PARTS LIST #5790****GIANT-VAC MODEL 16-WJ-SP**

REV. 1 - OCT 1998

REF NO.	DESCRIPTION	PART NO.	QTY
<b><u>BODY</u></b>			
1	Engine base & blower housing	10161	1
2	3/8 x 5/8 hex bolt (housing sealing bolts)	31035	3
3	3/8 lockwasher	31008	3
4	Front deflector door	24610	1
5	Control knob	31103	1
6	Door spring	31422	1
7	1/4 x 5/8 hex bolt (door pivot bolt)	31635	1
8	1/4 lockwasher	31013	1
9	Bushing	31014	1
10	Side deflector door	24609	1
11	3/8 x 5/8 hex bolt (door pivot bolt)	31035	2
12	3/8 lockwasher	31008	2
13	Baffle & front caster mount	20210	1
14	5/16 x 3/4 Self threading bolt	31572	8
15	Front caster unit	33190	1
16	3/8 x 1-1/4 hex bolt (caster mounting bolt)	31097	4
17	3/8 flatwasher	31034	4
18	3/8 lockwasher	31008	4
19	3/8 hex nut	31009	4
20	Transmission & idler assy mounting bracket	27280	1
21	3/8 x 1 hex bolt (bracket mounting bolt)	31389	6
22	3/8 flatwasher	31034	6
23	3/8 lockwasher	31008	6
24	3/8 hex nut	31009	6
<b><u>ENGINE , TRANS &amp; DRIVE IDLER</u></b>			
25	1/4 x 2-1/8 engine shaft key (front & rear)	31438	2
26	Impeller	21564	1
26a	Impeller hub	21559	1
26b	5/16 x 1" hex bolt	31282	3
26c	5/16 lockwasher	31003	3
27	Engine rear shaft pulley (unit drive pulley)	36131	1
28	3/8 x 4" threaded rod (trans support)	31683	1
29	3/8 hex nut	31009	2
30	Idler boss	36239	1
31	Idler pulley	36240	1
32	3/8 x 2-1/2 hex bolt (secures pulley & boss)	31357	1

REF NO.	DESCRIPTION	PART NO.	QTY
---------	-------------	----------	-----

**ENGINE, TRANS & DRIVE IDLER (CONT)**

33	3/8 flatwasher	31034	2
34	3/8 lockwasher	31008	2
35	3/8 hex nut	31009	2
36	Idler tensioning rod (3/8 x 4" threaded rod)	31683	1
37	3/8 lockwasher	31008	2
38	3/8 hex nut	31009	2

**Items Not Shown – Engine, Trans & Drive Idler:**

	16 HP Kohler OHC engine	39068	1
	5/16 x 1-3/4 hex bolt (engine mounting hardware)	31002	4
	5/16 lockwasher ( " )	31003	4
	5/16 hex nut ( " )	31004	4
	Muffler support bracket	27281	1
	3/8 x 1 hex bolt (support bracket mounting hardware)	31389	2
	3/8 lockwasher ( " )	31008	2
	3/8 hex nut ( " )	31009	2
	Engine shaft - rear	36238	1
	Mounting bolt (Engine rear shaft hardware)	31685	4
	5/16 lockwasher ( " )	31003	4
	Transmission	33192	1
	5/16 x 3/4 self threading bolt (trans mounting hardware)	31572	4
	5/16 lockwasher ( " )	31003	4
	Drive belt	36241	1

**DRIVE UNIT ASSEMBLY**

39	Differential/axle unit	36242	1
40	1" bearing unit	36243	2
41	3/8 x 1 hex bolt	31389	4
42	3/8 flatwasher	31034	4
43	3/8 lockwasher	31008	4
44	3/8 hex nut	31009	4
45	1" shaft lock collars	31062	2
46	1/4 x 2-1/8" axle key	31438	2
47	4.10 x 3.50 x 6 tire & wheel	33191	2
48	1" snap ring	31200	4
49	Jack shaft	36245	1
50	3/4" bearing unit	36244	2
51	5/16 x 1 hex bolt	31032	4
52	5/16 lockwasher	31003	4

REF NO.	DESCRIPTION	PART NO.	QTY
---------	-------------	----------	-----

**DRIVE UNIT ASSEMBLY (CONT.)**

53	5/16 hex nut	31004	4
54	3/4" shaft lock collar	31653	2
55	3/16 x 3-3/4" shaft key	31682	1
56	Large transfer gear	36246	1
57	Small transfer gear	36247	1
58	Trans drive chain guard	37122	1
59	#10 x 1/2 sheet metal screw	31573	2

**Items Not Shown – Drive Unit Assembly:**

	Drive chain (trans to jack shaft - small transfer gear)	36248	1
	Drive chain (jack shaft - large transfer gear - to differential)	36249	1
	Drive chain master link	36207	2

**DRIVE ENGAGEMENT ASSEMBLY**

60	Drive engagement bar	23208	1
61	3/4" bearing unit	36244	2
62	1/4 x 1-3/4 hex bolt	31684	4
63	1/4 lockwasher	31013	4
64	1/4 hex nut	31030	4
65	Upper connecting rod	23209	1
66	3/8 LH ball joint	31401	1
67	3/8 RH ball joint	31402	1
68	3/8 lockwasher	31008	1
69	3/8-24 jam nut	31568	3
70	Intermediate engagement lever	23210	1
71	5/8" bearing unit	36153	2
72	1/4 x 5/8 hex bolt	31635	4
73	1/4 lockwasher	31013	4
74	1/4 hex nut	31030	4
75	Intermediate engagement lever pivot bracket	23211	1
76	3/8 x 1 hex bolt	31389	2
77	3/8 flatwasher	31034	2
78	3/8 lockwasher	31008	2
79	3/8 hex nut	31009	2
80	Lower engagement rod	23181	1
81	Rod fitting end	31383	1
82	3/8 fender washer	31578	1
83	#2 bridge pin	31382	1
84	5/16 ball joint	31288	1

	DESCRIPTION	PART NO.	QTY
<b><u>DRIVE ENGAGEMENT ASSEMBLY (CONT.)</u></b>			
85	5/16 lockwasher	31003	1
86	5/16-24 jam nut	31569	2
<b><u>HANDLE ASSEMBLY</u></b>			
87	Upper handle	23200-A	1
88	Handle brace	23004	1
89	5/16 x 1-3/4 hex bolt	31002	2
90	5/16 lockwasher	31003	2
91	5/16 hex nut	31004	2
92	Handle brace extension bracket	23212	1
93	3/8 x 1 hex bolt	31389	1
94	3/8 lockwasher	31008	2
95	3/8 hex nut	31009	2
96	Lower handle	23002	2
97	5/16 x 1-3/4 hex bolt	31002	6
98	5/16 lockwasher	31003	6
99	5/16 hex nut	31004	6
100	Mid-handle support bracket	27282	1
101	5/16 x 3/4 self threading bolt	31572	1
102	5/16 flatwasher	31027	2

**Items Not Shown – Handle Assembly:**

	Foam handle grip	31590	1
--	------------------	-------	---

**ELECTRICAL**

103	Battery holddown bracket	31612	1
104	#10 x 1/2 sheet metal screw	31573	2

**Items Not Shown – Electrical:**

	Battery (with overflow tube)	39058	1
	Rubber battery top protector	31681	1
	Battery cable - positive	31679	1
	Battery cable - ground	31680	1