

INSTRUCTIONS FOR OPERATING YOUR GIANT-VAC  
MODELS 57-A - 59-A - 574-A - 596-A

As you unpack your Giant-Vac power unit, you will find the following parts:

- 1 - Power unit with motor, impeller and wheels.
- 1 - Set of handles in four parts.
- 1 - Nose cone
- 1 - Exhaust elbow.
- 1 - Dust control bag.
- 1 - Lifter handle.
- 1 - Package of nuts, bolts and washers.

Inspect parts for any damage that might have occurred during transit. If any is found, save the packing box and IMMEDIATELY notify the transport carrier who delivered your machine as he is responsible for the damage and is the only one to make any adjustments. Before leaving our plant, all components were completely inspected. All manufacturing dimensions are held to close tolerances, and thus, you will have little difficulty in assembling your Giant-Vac if you follow these instructions.

**CAUTION**  
ROTATING PARTS

BEFORE MAKING ANY ADJUSTMENTS OR REPAIRS  
STOP ENGINE AND REMOVE SPARK PLUG WIRE.  
WHILE IN OPERATION, KEEP ALL PARTS OF BODY  
AWAY FROM INTAKE AND EXHAUST SECTIONS.

MOTOR INSTRUCTIONS: You have received a complete engine manual with your machine. Be sure to note instructions on OILING. FILL OUT WARRANTY CARD IMMEDIATELY and send it to the engine manufacturers, as directed, as they are responsible for the operation of this engine and will service it. If you have any difficulties with the engine, it is best to contact the engine manufacturer rather than us, as much time will be saved.

WHEELS - HANDLE AND THROTTLE CONNECTIONS: To mount back wheels, use Bolt Ref. #16 and Nut Ref. #17 and mount into the top hole on under carriage Ref. #4. Hold bolt and tighten nut to under carriage. The front wheels on Model 574-A are casters. To mount, put wheel Ref. #21 into collar on under carriage and lock set screw. To mount front wheel on Model 596-A, put bolt Ref. #24 and Nut Ref. #17 on wheel to under carriage. Hold bolt and tighten nut to under carriage.

HANDLE AND THROTTLE CONNECTIONS: The handles are made in four parts and have a telescopic fit. The handles and handle brace should be completely assembled and then fastened to the blower as a unit. When assembling the handles, it is important that you DO NOT TIGHTEN ANY OF THE BOLTS until the assembly operations are complete. With the bolts loose, there will be enough movement to permit fast and easy assembly. Proceed as follows: Insert the two lower handles into the top handle until the bolt holes are in line. Fasten the handle brace to the handles with two 5/16 inch diameter bolts 1 3/4" long, lockwashers and nuts. In order to avoid tearing the bag, THE HEAD OF THE BOLTS SHOULD FACE THE BAG, ACORN NUTS ON THE OUTSIDE. DO NOT TIGHTEN THESE BOLTS. The handle assembly is now ready to attach to the blower. Fasten the lower handle to the blower base with a 3/8 inch nut and lockwasher. Now that the handles are assembled to the machine, tighten all bolts. Take the throttle cable and run it about two inches below the top brace. The throttle lever is then secured to the handle by means of two 3/16" bolts 1 1/2" long, lockwashers and nuts. Next, make sure you have left a generous loop between the motor and the bottom clip. THIS IS IMPORTANT to prevent the throttle binding. After starting your engine, adjust the

length of cable by loosening the screw at the throttle control for proper motor operation. Next, fasten the exhaust elbow to the power head by means of the 5/16" x 3/4" bolt and lockwasher and wingnuts. The nose cone slides on the front section of the blower and is held by means of a 5/16" x 3/4" bolt and lockwasher. Next, put the lifter handle "U" clip Ref. #12 onto the side of the upper handle. Then bolt the upper lifter arm Ref. #8 to the lower lifter arm Ref. #7 with two 5/16" x 3/4" bolts and nuts. Next, put the lower lifter arm through "U" clip and bolt to lifter cam Ref. #5. To operate lifter handle, push handle to the front of the machine and lock in "U" clip. Then pull back to lower nose cone.

DUST CONTROL BAG: The bag is held in place over the exhaust nozzle by means of a draw string. Loops at the opposite end fit over the handle bar. This is a large capacity bag designed to keep dust to a minimum. This allows the bag to be filled completely. It should be cleaned periodically. One way to thoroughly clean the bag is to leave the zipper open and run the engine for a few minutes while shaking the bag vigorously. Turning the bag inside out and sweeping briskly with a stiff broom is sometimes desirable when the bag is extremely dirty. To avoid injury, DO NOT STAND BEHIND THE OPENING WITH THE ZIPPER OPEN WHILE THE ENGINE IS RUNNING. The bag must be kept clean for efficient operations of your Giant-Vac. Four bags can be dry cleaned in a coin machine. IMPORTANT - Never wash a bag as the pores will shrink. A bag must be porous as many thousands of cubic feet of air per minute escape through the pores of the bag. If the pores become closed, the operational efficiency of your machine will be greatly reduced. The bag should always be emptied when a job is completed. Debris should never be left in the bag when machine is not in use.

BLOWING ATTACHMENT: The blowing attachment comes in a separate package and is available as an extra. It contains the exhaust blowing nozzle and the front baffle plate. These are fastened to the power unit with the bolts supplied with the power unit assembly. When using the blowing unit, it is IMPORTANT to install the front baffle plate to shield the high speed impeller. Remember that high speed moving parts should be treated with care. We have installed safeguards. BE SURE TO USE THEM. Changing the speed of your engine, changes the force of your exhaust. By using this method, you can move litter into a neat row at a very rapid rate. In operation, it is best to bear down on the handles so that the front assembly is raised slightly off the ground. The wheel assembly should be mounted at the front setting.

HOSE ATTACHMENT: A hose attachment kit is available as an additional attachment. This package contains an intake flange which connects to the front of the blower housing, a 10 foot length of 4 inch hose, and clamps. The hose is secured to the intake flange by means of a second clamp. This attachment is ideal for such uses as cleaning inside cars, leaves from around bushes, beddings and trees. It will accomplish countless other chores.

WARRANTY: Within 90 days from the purchase date, Giant-Vac Mfg. Incorporated will replace free of charge for the original purchaser, any part or parts returned to our factory at South Windham, Connecticut and found by us to be defective in material and/or workmanship.

The bags are made from specially woven long fibre material. They are carefully inspected before shipment. Bags, however, are an expendable item, and therefore, can not be guaranteed.

APRIL 3, 1984

## PARTS LIST NO. 5757

REF. #	PART NO.	DESCRIPTION	57-A	59-A	574-A	596-A
1	10093	Blower Housing & Engine Base	1	1	1	1
2	24510	Exhaust Elbow	1	1	1	1
3	27000	Nose Cone	1	1	1	1
4	27001	Under Carriage	1	1		
4	27053	Under Carriage			1	1
5	27002	Lifter Cam	1	1		
5	27054	Lifter Cam			1	1
6	21501	Impeller	1	1	1	1
7	23036	Lower Lifter Arm	1	1	1	1
8	23037	Upper Lifter Arm	1	1	1	1
9	23005	Upper Handle	1	1	1	1
10	23034	Lower Handle Right	1	1	1	1
11	23034	Lower Handle Left	1	1	1	1
12	31102	Lifter Handle - "U" Clip w/Nut	1	1	1	1
13	35002	Throttle Cable 50"	1	1	1	1
14	31007	Throttle Clip	1	1	1	1
15	33000	Wheel 10 x 250 Semi-Pneu.	2	2		
15	33041	Wheel 20" O.D.			2	2
16	31109	Bolt Hex Head 3/4" x 5"			2	2
16	31021	Bolt 1/2" x 4 1/2"	2	2		
17	31110	Nut 3/4"			2	2
17	31022	Nut 1/2"	2	2		
18	31023	Flat Washer 3/4"			2	2
18	31023	Flat Washer 3/4"	2	2		
19	33042	Spacer Set Back Wheel	1	1	1	1
19	33007	Spacer 1" x 2 1/2"	2	2		
20	33008	Axle 18 5/16"	1	1		
20	33044	Axle 22"			1	1
21	33009	Caster Wheel Plain Stem 4"	2		2	
22	31024	Set Screw	2		2	
23	33010	Wheel 8" x 175 Semi-Pneu.		2		2
24	31025	Bolt 1/2" x 3"		2		2
25	31026	T-Bolt	1	1	1	1
26	31018	Key & Lockwasher 5/16 x 1 1/2"	1	1	1	1
27	31031	Bolt - Hex Head 5/16 x 3/4"	4	4	4	4
28	31003	Lockwasher 5/16"	4	4	4	4
29	31336	Wingnuts 5/16"	4	4	4	4
30	31028	Acorn Nut 5/16"	2	2	2	2
31	31029	Screw Head 5/16 x 1 1/2"	2	2	2	2
32	31016	Bolt 5/16 x 5/8"	4	4	4	4
33	31055	Bolt, Washer & Wingnut 1/4" x 5/8"	2	2	2	2
34	24513	Blower Chute Deflector	1	1	1	1
35	31010	Bolt, Nut & Lockwasher 10-24 X 1 1/4"	2	2	2	2
36	24512	Blower Air Chute	1	1	1	1

REF.#	PART NO.	DESCRIPTION	57-A	59-A	574-A	596-A
37	20103	Blower Intake Baffle	1	1	1	1
38	31105	Rubber Gasket for Elbow	1	1	1	1
39	23011	Handle Brace	1	1	1	1
40	31057	Bolt, Nut & Washer 1 3/4" x 5/16"	4	4	4	4
41	31058	Nut & Lockwasher 3/8"	1	1	1	1
42	20106	Intake Flange 4"	1	1	1	1
43	34002	Hose Clamp 4"	1	1	1	1
44	34002	Hose 4" x 10'	1	1	1	1
45	20145	Intake Nozzle 4"	1	1	1	1
46	31004	Nut 5/16"	2	2	2	2
	39001	5HP B&S Engine	1	1	1	1
	121	Dust Control Bag	1	1	1	1

April 3, 1984

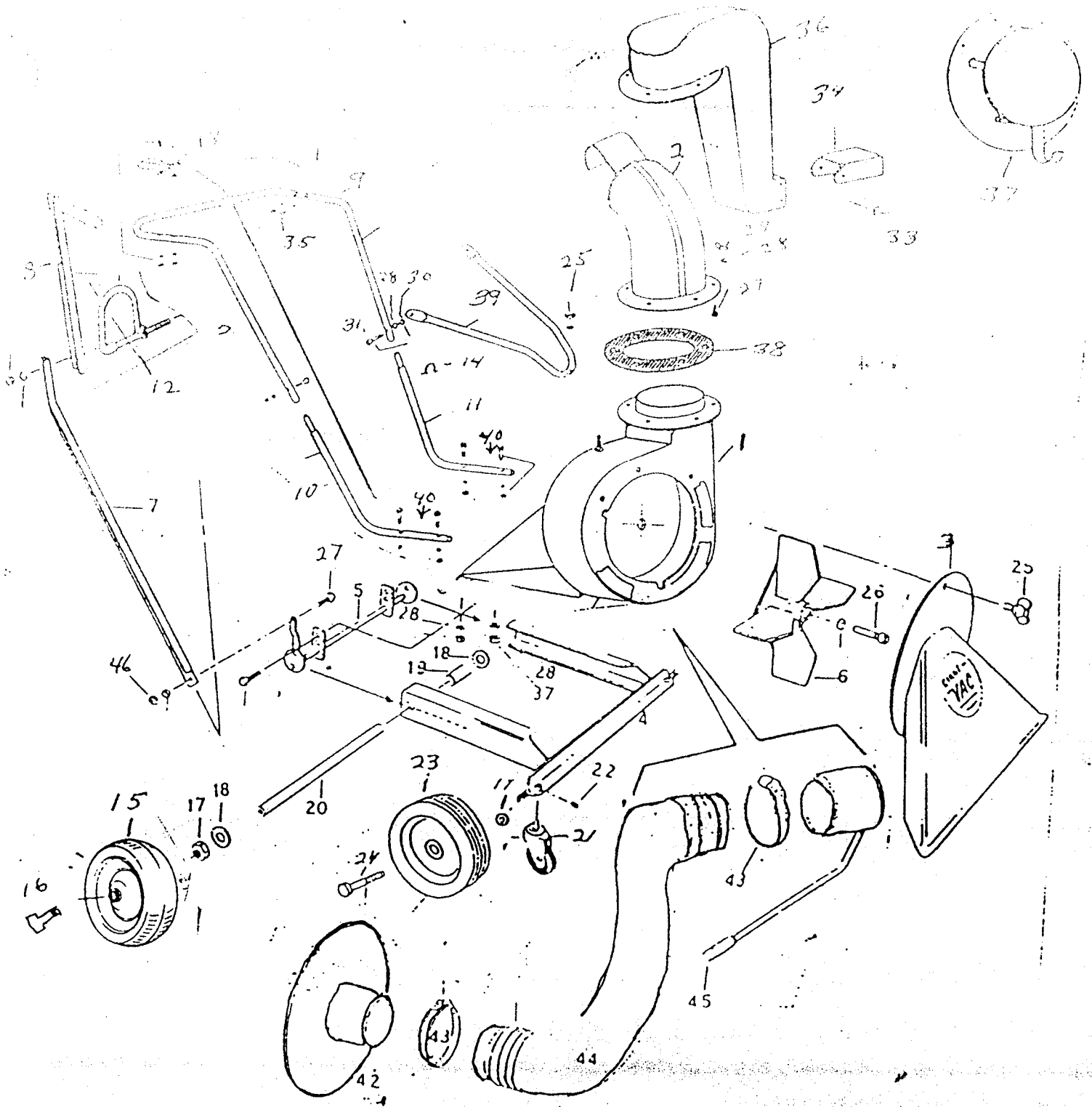

MODELS: 57-A - 59-A  
 574-A - 596-A

PARTS LIST NUMBER 5757  
 FOR MACHINES BUILT AFTER  
 APRIL 1, 1984