

INSTRUCTIONS FOR ASSEMBLING AND OPERATING YOUR GIANT-VAC
MODELS: 854-B - 854-B-IC - 854-K - 856-B - 856-B-IC - 856-K

As you unpack your Giant-Vac power unit, you will find the following parts:

- 1 - Power unit with motor, impeller and wheels.
- 1 - Set of handles in three parts.
- 1 - Handle brace.
- 1 - Package of hardware.

Inspect parts for any damage that may have occurred in shipping. If any are found, save the packing box and **IMMEDIATELY** notify the transport carrier who delivered your machine, as they are responsible for the damage and are the only ones to make any adjustments. Before leaving our plant, all dimensions are held to close tolerances, and thus, you will have little difficulty in assembling your Giant-Vac if you follow these steps.

CALIFORNIA PROPOSITION 65 WARNING

Gasoline and Diesel engine exhaust and some of its constituents are known to the State of California to cause cancer, birth defects and other reproductive harm.

As an owner of off-road gasoline or diesel engine equipment and/or as an employer, you also may have an obligation under the California Occupational Safety and Health Act or under Proposition 65 to warn persons exposed to gas and diesel exhaust and/or other Proposition 65 chemicals in and around your workplace. See California Health and Safety Code section 25249.5., Title 22 of the California Code of Regulations at section 1200 *et seq.*, and Title 8 of the California Code of Regulations section 5194.

WHEELS - HANDLE AND THROTTLE CONNECTIONS: To mount the back wheels, use bolt, Ref. #21, and nut, Ref. #20, and mount in the top hole on the undercarriage, Ref. #13. Hold bolt and tighten nut to undercarriage. The front wheels on Model 854 are casters. To mount them, put wheels, Ref. #26, into the collars on the undercarriage. To mount front wheels on Model 856, attach bolt, Ref. #23, and nut, Ref. #24, to the wheel then to the undercarriage.

The handles are made in three parts and have a telescopic fit. The handles and handle brace should be completely assembled and then fastened to the vac as a unit. When assembling the handles, it is important that you **DO NOT TIGHTEN ANY OF THE BOLTS** until the assembly operations are complete. With the bolts loose, there will be enough movement to permit fast and easy assembly. Proceed as follows: Insert the two lower handles into the upper handle until the bolt holes are in line. Fasten the handle brace to the handles with the two 5/16 x 1-1/2" round head bolts, lock washers and acorn nuts. In order to avoid tearing the bag, **THE HEADS OF THE BOLTS SHOULD BE ON THE INSIDE OF THE HANDLES AND THE ACORN NUTS ON THE OUTSIDE. DO NOT TIGHTEN THESE BOLTS YET.** The handle assembly is now ready to attach to the vac. Fasten the lower handles to the base with four 5/16 x 1-3/4" hex bolts, lock washers and nuts. **DO NOT TIGHTEN THESE BOLTS YET.** Next, install the handle brace to the stud on the housing with a 3/8" lock washer and nut. Now that the handles are assembled to the machine **TIGHTEN ALL THE BOLTS.** Take the throttle cable and run it along the left side of the handle about 1/3 its length. Secure it with a clip about two inches below the brace. The throttle lever is secured to the handle by means of two 10-24 x 1-1/2" bolts, lock washers and nuts. Put the second clip just below the curve in the upper handle. Make sure you have left a generous loop between

the engine and the bottom clip. THIS IS IMPORTANT to prevent the throttle binding. After starting your engine, adjust the length of cable by loosening the screw at the throttle lever for proper engine operation. Next, put the lifter hand U-clip, Ref. #17, on the right side of the upper handle, replacing the acorn nut used in assembling the handles. Then put the upper lifter arm, Ref. #16, through the U-clip and bolt the lower lifter arm, Ref. #15, to it with two 5/16 x 3/4" hex bolts, lock washers and nuts. Then bolt the lower lifter arm to the lifter cam, Ref. #14. To operate lifter handle, push handle to front of the machine and lock in U-clip, then pull back to adjust nose cone height.

ATTACHMENTS: Your Giant-Vac is extremely versatile, therefore, many attachments are available. These are easily interchangeable and fasten to your machine as follows:

All attachments which are fastened to the suction end of the machine (the large round hole in the front) are secured by 3/8" wing bolts and lock washers. All attachments for the exhaust end of the machine (the smaller hole at the top of the housing) are fastened with 5/16 x 1" bolts, lock washers and wing nuts. This hardware is found in the package shipped with the power unit.

VACUUM UNIT: The vacuum unit, separately packaged, contains the nose cone, discharge elbow and dust control bag. These are attached to the power unit by means of the screws, as described in the foregoing paragraph. The nose cone, Ref. #2, is attached to the suction end of the machine and the exhaust elbow, Ref. #6, is attached to the exhaust end of the machine. In general, if your Giant-Vac is being used on an even surface, a 5/8" clearance for the nose cone is desirable. The brush at the back of the nose cone is easily raised or lowered by loosening two bolts and sliding the brush and brush holder by means of the adjustment slots provided. The height of the brush depends upon the particular application. Remember to re-tighten the bolts after making any adjustments. For the 30F or 36F nose cones, bolt the lifter handle U-clip, Ref. #28, on the top right side of the upper handle, using the 1/4" lock nut Ref. #61. Next, put the upper adjuster bar, Ref. #29, through the U-clip and bolt the lower adjuster bar, Ref. #30, to it with two 5/16 x 3/4" hex bolts, lock washers and nuts. Then bolt the lower adjuster bar to the door on the nose cone, using a 5/16 x 3/4" hex bolt and 5/16" lock nut. To operate handle, push handle to front of the machine, then pull back and lock in U-clip. This will open and close the nose cone door for ease in picking up bulky items, such as cans and bottles.

DUST CONTROL BAG: The bag is held over the exhaust elbow by means of a fast tightening, locking buckle. A loop at the opposite end fits over the upper handle. This is a very large capacity bag, designed to keep dust to a minimum. A vent is added at the upper end of the zippered opening for faster pick-up on some applications. This also allows the bag to be filled completely. It should be emptied daily. One way to clean the bag is to leave the zipper open and run the engine for a few minutes while shaking the bag vigorously. Turning the bag inside out and sweeping briskly with a stiff broom is sometimes desirable when the bag is extremely dirty. A 510 liner bag is recommended for exceeding dusty applications. It fits inside the regular 210 dust control bag. **TO AVOID INJURY - DO NOT STAND BEHIND THE OPENING WITH THE ZIPPER OPEN WHILE THE ENGINE IS RUNNING.** It is important that the bag be kept clean for efficient operation of your Giant-Vac. Occasional dry cleaning is recommended.

OPTIONAL ATTACHMENTS

BLOWING ATTACHMENT: The blower attachment is a separate package, which contains the exhaust blowing nozzle with an adjustable vane and the front baffle plate. These are fastened to the power unit assembly with the exhaust blower attaching where the exhaust elbow goes and the baffle going on the front where the nose cone attaches. This is done with the bolts supplied with the power unit assembly. When

using the blower unit, it is important to install the front baffle plate to shield the high speed impeller. The blower unit can be mounted so that it is either facing the side or the front of the machine. Changing the speed of your engine changes the force of the exhaust. By using this method, you can move litter into a neat row at a very rapid rate. In operation, it is best to bear down on the handles so that the front assembly is raised slightly off the ground. The wheel assembly should be mounted at the front setting. Do not pass or stand on the air discharge side of the blowing nozzle when the engine is running. Sop operation when another person or an animal approaches.

**REMEMBER - HIGH SPEED MOVING PARTS SHOULD BE
TREATED WITH CARE. WE HAVE INSTALLED SAFEGUARDS..
BE SURE TO USE THEM!!**

HOSE ATTACHMENTS: Many hose attachments are available for both vacuuming and blowing operations. These are all mounted in the same manner as the foregoing. They are ideal for cleaning leaves from hedges, chimneys and stair wells, as well as, other applications.

MOTOR INSTRUCTIONS: You have received a complete engine manual with your machine. Be sure to especially note the instructions on **OILING**. **ALL MACHINES ARE SHIPPED WITHOUT OIL OR GASOLINE UNLESS OTHERWISE NOTED**. If you have any difficulties with the engine, check the Yellow Pages of your phone book for the engine dealer nearest you, rather than us, as the engines are under their own manufacturer's warranty.

SAFETY AND OPERATING INSTRUCTIONS

TRAINING:

1. Regard your Giant-Vac as a piece of power equipment and teach this regard to all who will operate this unit.
2. **NEVER** allow children or young teenagers to operate the Giant-Vac.
3. Be sure you know how to stop the engine at a **MOMENTS NOTICE**.
4. Instruct children to keep away from the area of operation at all times.
5. Keep the Leaf Vac and fuel container in locked storage to prevent children from playing and/or tampering with them.
6. Gasoline powered equipment or fuel containers should not be stored in a basement or any closed area where heating or heat appliances or open pilot lights are present, unless the fuel is completely drained from the power equipment and the fuel containers.

PREPARATION:

1. Before starting operation, clear the entire work area of all debris that could catch on or be thrown by the Leaf Vac.
2. Unless there is very good artificial light, use only during daylight.
3. Fill gasoline driven machines outdoors. Avoid spilling gasoline and **DO NOT** fill while the engine is running or while you are smoking.

OPERATION:

1. Do not operate with any guards or component parts removed from unit.
2. Before making any adjustments or repairs, stop engine and remove spark plug wire.
3. While in operation, keep all parts of body away from intake and exhaust sections.
4. When operating machine, keep people and pets a safe distance away.
5. Before starting, be certain to check the engine's OIL AND GASOLINE. (See engine manufacturer's Service Manual.) **NEVER** check the engine while engine is running or while you are smoking. Check **ONLY** when engine is cold.
6. Before starting the engine, be certain the unit is completely assembled. With your right hand, set the throttle control to the "on" position. When the engine is cold, you might have to choke the engine. (The choke lever is next to the carburetor.) Next, with your left hand, pull the recoil starter rope slowly until you feel compression, then pull fast and steady. Do not let the recoil

starter rope snap back by itself. This may damage the rope or recoil starter assembly. After the engine starts, move the throttle lever down to approximately halfway.

MAINTENANCE AND STORAGE:

1. Follow implicitly the manufacturer's recommendations for maintenance.
2. Never adjust the Leaf Vac or change attachments until the engine has been turned off and the spark plug wire has been disconnected.
3. If carburetor adjustment is necessary, stand to one side and keep feet and hands in the clear while making adjustments.
4. Keep engine free from accumulations of grass, leaves or excessive grease. An accumulation of these combustible materials may result in a fire.
5. Store gasoline in a safe and approved container in a cool dry place.

GIANT-VAC WARRANTY

GIANT-VAC MFG. INCORPORATED, here-in-after called Giant-Vac, warrants each new Giant-Vac to the original retail purchaser of the new Giant-Vac equipment to be free from manufacturing defects in normal service for a period of 90 days, unless it is used for rental purposes, which limits the warranty to 30 days. This warranty does not apply to engines, tires or other parts that are purchased and warranted by their manufacturer. Items such as bags, grass catchers, hoses and blades are not warranted, as these are considered expendable items. This warranty does not include equipment failures due to normal wear.

Any obligation under this warranty is expressly limited to the replacement or repair, at an authorized servicing Giant-Vac dealer, or at a point designated by us, of such parts as appear to us to have been defective. All defective parts have to be returned freight prepaid before credit will be issued.

We shall not be liable for transportation charges in connection with the replacement or repair of defective parts.

This warranty does not apply to a Giant-Vac upon which repairs or alterations have been made by others except with our prior written approval.

We shall not be liable for consequential damages or contingent liabilities for the fitness of any Giant-Vac for any particular purpose.

We make no other express, implied or statutory warranty, nor is anyone authorized to make any in our behalf.

GIANT-VAC MFG. INCORPORATED
P.O. BOX 195
SOUTH WINDHAM, CT. 06266
PHONE: 860-423-7741 FAX: 860-423-2654

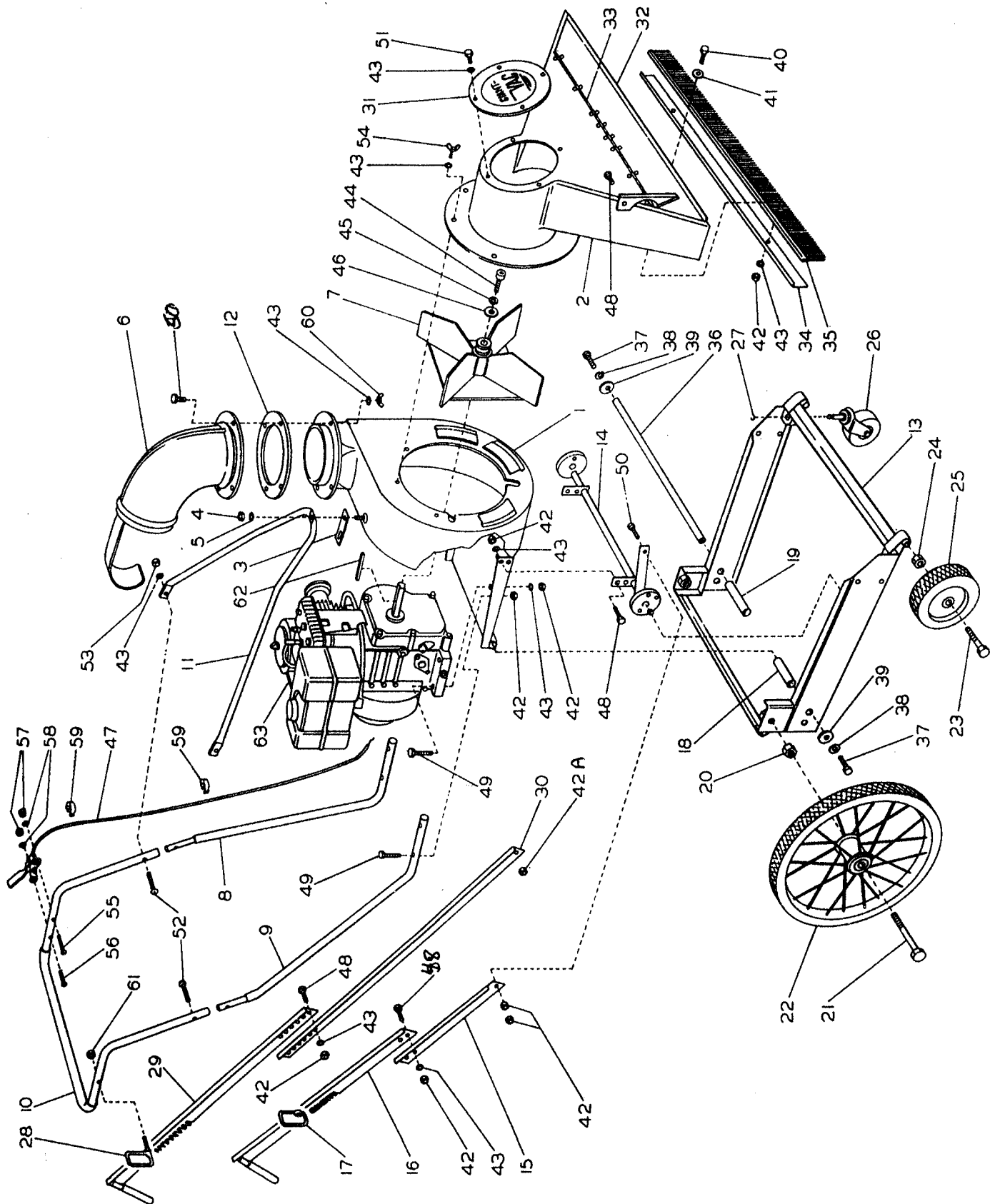

PARTS LIST NO. 5719

<u>REF.</u> <u>NO.</u>	<u>PART</u> <u>NO.</u>	<u>DESCRIPTION</u>	<u>854-B</u>	<u>854-B-IC</u>	<u>854-K</u>
1	10097	Blower housing & engine base	1	1	
1	10098	Blower housing & engine base			1
2	27059	30F nose cone body	1	1	1
2	27061	36F nose cone body	1	1	1
2-A	27058	30C nose cone body	1	1	1
2-A	27060	36C nose cone body	1	1	1
3	31591	Anti-vibration bracket	1	1	1
4	31009	3/8" hex nut	1	1	1
5	31115	3/8" lock washer	1	1	1
6	24510	Exhaust elbow	1	1	1
7	21503	Impeller	1	1	1
8	23013	Lower handle left	1	1	1
9	23010	Lower handle right	1	1	1
10	23009	Upper handle	1	1	1
10-A	31590	Foam handle cover	1	1	1
11	23011	Handle brace	1	1	1
12	31105	Rubber gasket	1	1	1
13	27055	Under carriage	1	1	
13	27148	Under carriage			1
14	27056	Lifter cam	1	1	1
15	23038	Lower lifter arm	1	1	1
16	23039	Upper lifter arm	1	1	1
16-A	31104	Handle grip	1	1	1
17	31111	Lifter arm "U" clip	1	1	1
18	33152	Spacer back wheel - right	1	1	1
19	33043	Spacer back wheel - left	1	1	1
20	31110	3/4" hex nut	2	2	2
21	31109	3/4 x 5" hex bolt	2	2	2
22	33041	Back wheel 20"	2	2	2
26	33009	4" caster wheel - plain stem	2	2	2
27	31024	Allen set screw 1/4 x 3/8"	2	2	2
28	31101	"U" type holder	1	1	1
29	23040	Upper adjuster bar	1	1	1
29-A	31104	Handle grip	1	1	1
30	23041	Lower adjuster bar	1	1	1
31	27064	Cover plate	1	1	1
32	27062	Door for 30F	1	1	1
32	27063	Door for 36F	1	1	1
33	27043	Hinge for 30F	1	1	1
33	27044	Hinge for 36F	1	1	1

<u>REF.</u> <u>NO.</u>	<u>PART</u> <u>NO.</u>	<u>DESCRIPTION</u>	<u>854-B</u>	<u>854-B-IC</u>	<u>854-K</u>
34	27019	Brush holder 30"	1	1	1
34	27020	Brush holder 36"	1	1	1
35	27010	30" brush	1	1	1
35	27011	36" brush	1	1	1
36	33045	22" back wheel axle	1	1	1
37	31044	1/2 x 1 hex bolt	2	2	2
38	31078	1/2" lock washer	2	2	2
39	31119	1/2" flat washer	2	2	2
40	31005	5/16 x 1 1/4" hex bolt	2	2	2
41	31145	5/16" flat washer	2	2	2
42	31004	5/16" hex nut	19	19	19
42-A	31436	5/16" lock nut	1	1	1
43	31003	5/16" lock washer	27	27	27
44	31020	7/16-20 x 2" impeller bolt	1	1	1
45	31020	7/16" lock washer & key	1	1	1
46	31020	7/16" spacer	1	1	1
47	35002	Throttle control	1	1	1
48	31031	5/16 x 3/4" hex bolt	7	7	7
49	31002	5/16 x 1 3/4" hex bolt	8	8	8
50	31032	5/16 x 1 hex bolt	5	5	5
51	31016	5/16 x 5/8" hex bolt	4	4	4
52	31056	5/16 x 1 1/2" round head bolt	2	2	2
53	31028	5/16 acorn nut	2	2	2
54	31026	3/8" T-bolt	3	3	3
55	31010	10-24 x 1 1/4" bolt	1	1	1
56	31010	10-24 x 1 1/4" bolt	1	1	1
57	31010	10-24 lock washer	2	2	2
58	31010	10-24 hex nut	2	2	2
59	31007	Throttle clip	2	2	2
60	31592	5/16" wing nut	4	4	4
61	31098	1/4" lock nut	1	1	1
62	31020	SEE #44, 45 & 46	1	1	1
63	39002	8 HP B&S engine	1		
63	39035	8 HP B&S I/C engine		1	
63	39007	8 HP Kohler engine			1

PARTS LIST NO. 5719

<u>REF.</u> <u>NO.</u>	<u>PART</u> <u>NO.</u>	<u>DESCRIPTION</u>	<u>854-B</u>	<u>854-B-IC</u>	<u>854-K</u>
<u>ITEMS NOT SHOWN</u>					
	24533	Blower air chute	1	1	1
	20101	Blower intake baffle	1	1	1
	24513	Blower chute deflector	1	1	1
	31055	1/4 x 5/8" bolt, wing nut & lock washer	2	2	2
	20151	DF1 hose holder 4"	1	1	1
	20152	DF1 hose holder 5"	1	1	1
	20153	DF1 hose holder 6"	1	1	1
	34002	Intake hose 4"	1	1	1
	34003	Intake hose 5"	1	1	1
	34004	Intake hose 6"	1	1	1
	34006	Intake hose 8"	1	1	1
	34018	Exhaust hose 7" x 10' metal	1	1	1
	34011	Hose clamp 4"	2	2	2
	34012	Hose clamp 5"	2	2	2
	34013	Hose clamp 6"	2	2	2
	34015	Hose clamp 8"	2	2	2
	34047	Squeeze ring 7"	1	1	1
	20145	Nozzle 4"	1	1	1
	20146	Nozzle 5"	1	1	1
	20147	Nozzle 6"	1	1	1
	20149	Nozzle 8"	1	1	1
	20106	Intake flange 4"	1	1	1
	20107	Intake flange 5"	1	1	1
	20108	Intake flange 6"	1	1	1
	20115	Intake flange 8"	1	1	1
	24511	Exhaust flange 7"	1	1	1
	210	Dust control bag	1	1	1
	510	Liner bag	1	1	1
	710	Polypropylene bag	1	1	1

PARTS LIST NO. 5719

<u>REF.</u> <u>NO.</u>	<u>PART</u> <u>NO.</u>	<u>DESCRIPTION</u>	<u>856-B</u>	<u>856-B-IC</u>	<u>856-K</u>
1	10097	Blower housing & engine base	1	1	
1	10098	Blower housing & engine base			1
2	27059	30F nose cone body	1	1	1
2	27061	36F nose cone body	1	1	1
2-A	27058	30C nose cone body	1	1	1
2-A	27060	36C nose cone body	1	1	1
3	31591	Anti-vibration bracket	1	1	1
4	31009	3/8' hex nut	1	1	1
5	31115	3/8" lock washer	1	1	1
6	24510	Exhaust elbow	1	1	1
7	21503	Impeller	1	1	1
8	23013	Lower handle left	1	1	1
9	23010	Lower handle right	1	1	1
10	23009	Upper handle	1	1	1
10-A	31590	Foam handle cover	1	1	1
11	23011	Handle brace	1	1	1
12	31105	Rubber gasket	1	1	1
13	27055	Under carriage	1	1	
13	27148	Under carriage			1
14	27056	Lifter cam	1	1	1
15	23038	Lower lifter arm	1	1	1
16	23039	Upper lifter arm	1	1	1
16-A	31104	Handle grip	1	1	1
17	31111	Lifter arm "U" clip	1	1	1
18	33152	Spacer back wheel - right	1	1	1
19	33043	Spacer back wheel - left	1	1	1
20	31110	3/4" hex nut	2	2	2
21	31109	3/4 x 5" hex bolt	2	2	2
22	33041	Back wheel 20"	2	2	2
23	31083	1/2 x 3" hex bolt	2	2	2
24	31022	1/2" hex nut	2	2	2
25	33010	8" x 1/2" semi-pneumatic tires	2	2	2
28	31101	"U" type holder	1	1	1
29	23040	Upper adjuster bar	1	1	1
29-A	31104	Handle grip	1	1	1
30	23041	Lower adjuster bar	1	1	1
31	27064	Cover plate	1	1	1
32	27062	Door for 30F	1	1	1
32	27063	Door for 36F	1	1	1
33	27043	Hinge for 30F	1	1	1

<u>REF.</u> <u>NO.</u>	<u>PART</u> <u>NO.</u>	<u>DESCRIPTION</u>	<u>856-B</u>	<u>856-B-IC</u>	<u>856-K</u>
33	27044	Hinge for 36F	1	1	1
34	27019	Brush holder 30"	1	1	1
34	27020	Brush holder 36"	1	1	1
35	27010	30" brush	1	1	1
35	27011	36" brush	1	1	1
36	33045	22" back wheel axle	1	1	1
37	31044	1/2 x 1 hex bolt	2	2	2
38	31078	1/2" lock washer	2	2	2
39	31119	1/2" flat washer	2	2	2
40	31005	5/16 x 1 1/4" hex bolt	2	2	2
41	31145	5/16" flat washer	2	2	2
42	31004	5/16" hex nut	19	19	19
42-A	31436	5/16" lock nut	1	1	1
43	31003	5/16" lock washer	27	27	27
44	31020	7/16-20 x 2" impeller bolt	1	1	1
45	31020	7/16" lock washer & key	1	1	1
46	31020	7/16" spacer	1	1	1
47	35002	Throttle control	1	1	1
48	31031	5/16 x 3/4" hex bolt	7	7	7
49	31002	5/16 x 1 3/4" hex bolt	8	8	8
50	31032	5/16 x 1 hex bolt	5	5	5
51	31016	5/16 x 5/8" hex bolt	4	4	4
52	31056	5/16 x 1 1/2" round head bolt	2	2	2
53	31028	5/16 acorn nut	2	2	2
54	31026	3/8" T-bolt	3	3	3
55	31010	10-24 x 1 1/4" bolt	1	1	1
56	31010	10-24 x 1 1/4" bolt	1	1	1
57	31010	10-24 lock washer	2	2	2
58	31010	10-24 hex nut	2	2	2
59	31007	Throttle clip	2	2	2
60	31592	5/16" wing nut	4	4	4
61	31098	1/4" lock nut	1	1	1
62	31020	SEE #44, 45 & 46	1	1	1
63	39002	8 HP B&S engine	1		
63	39035	8 HP B&S I/C engine		1	
63	39007	8 HP Kohler engine			1

PARTS LIST NO. 5719

<u>REF.</u> <u>NO.</u>	<u>PART</u> <u>NO.</u>	<u>DESCRIPTION</u>	<u>856-B</u>	<u>856-B-IC</u>	<u>856-K</u>
<u>ITEMS NOT SHOWN</u>					
	24533	Blower air chute	1	1	1
	20101	Blower intake baffle	1	1	1
	24513	Blower chute deflector	1	1	1
	31055	1/4 x 5/8" bolt, wing nut & lock washer	2	2	2
	20151	DF1 hose holder 4"	1	1	1
	20152	DF1 hose holder 5"	1	1	1
	20153	DF1 hose holder 6"	1	1	1
	34002	Intake hose 4"	1	1	1
	34003	Intake hose 5"	1	1	1
	34004	Intake hose 6"	1	1	1
	34006	Intake hose 8"	1	1	1
	34018	Exhaust hose 7" x 10' metal	1	1	1
	34011	Hose clamp 4"	2	2	2
	34012	Hose clamp 5"	2	2	2
	34013	Hose clamp 6"	2	2	2
	34015	Hose clamp 8"	2	2	2
	34047	Squeeze ring 7"	1	1	1
	20145	Nozzle 4"	1	1	1
	20146	Nozzle 5"	1	1	1
	20147	Nozzle 6"	1	1	1
	20149	Nozzle 8"	1	1	1
	20106	Intake flange 4"	1	1	1
	20107	Intake flange 5"	1	1	1
	20108	Intake flange 6"	1	1	1
	20115	Intake flange 8"	1	1	1
	24511	Exhaust flange 7"	1	1	1
	210	Dust control bag	1	1	1
	510	Liner bag	1	1	1
	710	Polypropylene bag	1	1	1

ALL SPECIFICATIONS SUBJECT TO CHANGE WITHOUT NOTICE. APRIL, 1995