THE GIANT-VAC

954-956 VAC

MODELS 954 - 956

OPERATOR'S MANUAL

Congratulations!

You have just purchased one of the finest pieces of outdoor power equipment on the market today. If properly cared for, your Giant-Vac 954/956 Vac will provide years of dependable service. Please read and follow this instruction manual carefully in order to get the most out of your new equipment.

As you unpack your unit, you will find the following parts in two cartons:

- 1 Carton containing:
 - Power unit
 - Handle assembly in four parts
 - Set front and rear wheels (front casters for 954)
 - Height adjustment lever assembly in two parts
 - Package of hardware and assembly components
 - Package containing operating manuals and warranty registration
- 1 Carton containing:
 - Nose cone
 - Discharge elbow
 - Debris bag

Your Giant-Vac 954/956 Vac requires very little assembly. Simply follow the instructions contained within this manual to begin enjoying the benefits of your new unit.

Each Giant-Vac product leaves our factory in excellent condition; occasionally, however, some damage may occur during shipment. If any such damage is found upon initial inspection, *immediately* notify the transport carrier who delivered your machine, as they are solely responsible for such damage, as well as any subsequent adjustments necessary.

CALIFORNIA PROPOSITION 65 WARNING

Gasoline and Diesel engine exhaust and some of its constituents are known to the State of California to cause cancer, birth defects and other reproductive harm.

As an owner of off-road gasoline or diesel engine equipment and/or as an employer, you also may have an obligation under the California Occupational Safety and Health Act or under Proposition 65 to warn persons exposed to gas and diesel engine exhaust and/or other Proposition 65 chemicals in and around your workplace. See California Health and Safety Code section 25249.5, Title 22 of the California Code of Regulations at Section 1200 *et seq.*, and Title 8 of the California Code of Regulations Section 5194.

10/01 Revision

1

SAFETY RULES REGARDING OUTDOOR POWER EQUIPMENT

IMPORTANT! READ THE FOLLOWING SAFETY RULES ***CAREFULLY*** BEFORE **ASSEMBLING** OR OPERATING UNIT:

- Regard your Giant-Vac as a piece of power equipment and teach this regard to all who will operate this unit. Never allow children or young teenagers to operate the unit.
- Always wear appropriate safety equipment when operating this unit. Proper eye, ear, and breathing protection is a must.
- Be sure you know how to stop both the unit and the engine at a **MOMENT'S NOTICE**. Refer to the operation section of this manual, as well as the engine manual.
- Do not operate with any guards or component parts removed from unit.
- Unless there is very good artificial light, use only during daylight.
- Fill gasoline driven machines outdoors. Avoid spilling gasoline and **DO NOT** fill the engine while it is running or while you are smoking.
- While in operation, keep all parts of body away from intake and exhaust sections. Never insert any body part or other foreign object in any opening while the machine is running.
- When operating unit, keep people and pets a safe distance away. Instruct children to keep away from the area of operation at all times.
- Do not use on steep inclines (over 30 degrees), as unit can roll over.
- Before making any adjustments or repairs, stop engine and remove spark plug wire.

FAILURE TO FOLLOW THESE RULES CAN RESULT IN CHRONIC HEALTH PROBLEMS, SERIOUS INJURY, OR EVEN DEATH.

2

UNIT ASSEMBLY

Note: Please refer to Parts List for correct part identification and placement

WHEEL ASSEMBLY

REAR WHEELS:

- Insert one 3/4 x 5" hex bolt (Parts List Ref. #21) into center hole of rear wheel (#22), securing with 3/4" nut (#20), threading nut snugly against hub of wheel. Repeat for other wheel.
- Thread end of bolt into top hole in rear of undercarriage (#13). Secure by tightening nut against undercarriage. Repeat for other wheel. Note: Wheel should spin freely but have no play. Adjust by turning bolt in or out.

FRONT WHEELS:

954:

- Remove spring clip (#27) from groove in top of caster (#26).
- Insert caster stud up through boss in front of undercarriage, securing with spring clip.

956:

- Insert one 1/2 x 2-1/2" hex bolt (Parts List Ref. #23) into center hole of front wheel (#25), securing with 1/2" nut (#24), threading nut snugly against hub of wheel.
- Thread end of bolt into threaded side hole in front bar of undercarriage (#13). Secure by tightening nut against undercarriage. Note: Wheel should spin freely but have no play. Adjust by turning bolt in or out.

HANDLE ASSEMBLY

- Slide swaged top of each lower handle (#8,9) into bottom portion of upper handle (#10), aligning holes in lower handles with corresponding holes in upper handle. Note: Lower handles should angle inwards at the bottom.
- Slide one 5/16 x 1-1/2" round slotted head screw (#52) out from the inside through each set of holes.
- Slip holes in forked end of handle brace (#11) over screw ends, securing with one 5/16 lockwasher (#28) and acorn nut (#30) on left side, lockwasher and u-clip nut (#17) on right, making sure clip faces upwards (see diagram). Note: be sure front end of handle brace is angled downward.
- Lower handle assembly onto unit, slipping front hole in handle brace onto threaded stud on top of blower housing (#1), and aligning holes in bottom of lower handles with corresponding holes in engine base. Secure brace with one 3/8 nut (#4) and lockwasher (#5), secure lowers with four 5/16 x 1-3/4 hex bolts (#49), lockwashers (#43) and nuts (#42). Tighten all bolts securely.

2

UNIT ASSEMBLY (cont.)

- Fasten throttle control (#47) to left outside of upper handle with two 10-24 x 1 1/2" bolts, lock washers and nuts (#55-58). Secure cable with two throttle clips (#59), placing one approximately two inches below the brace, the second just below the curve in the upper handle. Be sure there is a generous loop between the engine and the bottom clip to avoid binding.

HEIGHT ADJUSTMENT LEVER ASSEMBLY

- Slip bottom end of upper lever (#16) down through clip. Teeth should face downward.
- Align holes in top of lower lever (#15) with holes in bottom of upper lever, securing with two 5/16 x 3/4" hex bolts (#48), lockwashers (#43) and nuts (#42).
- Connect bottom of lever to pivot bar of height adjustment cam (#14) with one 5/16 x 3/4" hex bolt (#48) and lock nut (#42a).

NOSE CONE ASSEMBLY

- Fasten nose cone (#2) to front of unit by slipping bottom of bolt ring into clips on front of housing, making sure to align holes in nose cone with holes in housing. Secure with three 3/8" thumb screws (#54) and lockwashers (#25a).
- If nose cone is equipped with flip-top auxiliary intake option ('F' type nose cone), assemble the door lever by first inserting u-clip with stud (#28) in through outside of upper right side of upper handle, securing with 1/4" lock nut (#61). Make sure u-clip faces upwards as in diagram. Slip bottom end of upper lever (#29) down through clip. Teeth should face downward. Align holes in top of lower lever (#30) with holes in bottom of upper lever, securing with two 5/16 x 3/4" hex bolts (#48), lockwashers (#43) and nuts (#42). Connect bottom of lever to handle on nose cone door (#32) with one 5/16 x 3/4" hex bolt (#48) and lock nut (#42a). Adjust lever, via adjustment holes at junction between upper and lower levers, so that door closes completely when lever is lowered and opens flush with bottom of nose cone when raised.

DISCHARGE ELBOW ASSEMBLY

- Fasten discharge elbow (#2) to top of unit by aligning holes in elbow bolt ring with holes in housing discharge and rubber gasket (#38), making sure discharge is directed toward back of unit.
- Slip one 5/16 x 1" hex bolt (27) up through each of the four sets of holes, securing with one lockwasher (#28) and wing nut (#29).

DEBRIS BAG ATTACHMENT

- Slide mouth of debris bag over discharge elbow, making sure tensioning strap clears anti-slip ridge of discharge elbow. Pull strap taut. Note: make sure bag is right-side up – observe lettering on bag.
- Secure rear of bag to upper handle with clip-on hanger straps.

Assembly of your Giant-Vac 954/956 Vac is now complete.

3

UNIT OPERATION

STARTING THE ENGINE

IMPORTANT NOTE: The procedures outlined within this section are general guidelines, and are in no way meant to replace or supercede engine manufacturer's operating instructions. In order to obtain optimum performance from your engine, refer to your engine manual.

BEFORE STARTING ENGINE:

- Be sure that the unit is completely assembled, all fasteners are tightened securely, and all safety guards and components are in place.
- Be sure to check engine's **oil** and **gasoline***. (See engine manual for recommended oil and gasoline specifications.) **Never** check the engine while it is running or while you are smoking. Check only when engine is cold.
*** All machines are shipped without oil or gasoline unless otherwise noted.**
- Be sure that fuel valve on engine is set to open position (if applicable).

TO START ENGINE :

- Set throttle control to "ON" position. If engine is cold, set choke (if so equipped). If your engine has a fuel prime button, depress it firmly three times.
- Grasp recoil handle and pull briskly. You may have to pull several times before engine starts. (If engine fails to start within a reasonable amount of time, discontinue and check engine manual for further instructions.) Note: Do not allow recoil rope to snap back into recoil; damage to the rope or recoil could result.
- After engine starts, move throttle control down to approximately half, and turn off choke.

TO SHUT ENGINE DOWN :

- Allow engine to idle for 2-3 minutes before shutting down.
- Set throttle control to 'off' position.
- If engine is not to be started for a prolonged period, turn fuel valve to closed position.

***IMPORTANT NOTE:** If you experience problems with your engine that cannot be satisfactorily resolved by following the instructions contained within the engine manual, contact your local engine dealer, or call the toll-free service number listed in the repair section of the engine manual. All engine service, warranty or otherwise, is required to be performed by a manufacturer-authorized service center. Giant-Vac, Inc. is neither authorized nor responsible for any type of warranty engine service, nor is it equipped to perform any such service.*

3

UNIT OPERATION (cont.)

OPERATING THE VACUUM

ADJUSTING THE NOSE CONE:

- The nose cone should be set to its highest position during transport.
- As a general rule, the heavier the debris being removed, the lower the nose cone should be set. For dry leaves, set the nose cone high and set engine throttle at approximately half. For wet or frozen leaves, set the nose cone low and increase engine throttle to between 3/4 and full.

EMPTYING THE DEBRIS BAG:

- Ideally the bag should be emptied daily; however, a weekly emptying will suffice.

CLEANING THE DEBRIS BAG:

- It is most important that the bag be kept clean for efficient operation of your Giant-Vac. One way to clean the bag is to leave the zipper open and run the engine for a few minutes while shaking the bag vigorously. **TO AVOID INJURY - DO NOT STAND BEHIND THE OPENING WITH THE ZIPPER OPEN WHILE THE ENGINE IS RUNNING.** Turning the bag inside out and sweeping briskly with a stiff broom is sometimes desirable when the bag is extremely dirty. Occasional dry cleaning is recommended.

4

MAINTENANCE AND STORAGE

- Follow **implicitly** the engine manufacturer's recommendations for maintenance.
- Never make any adjustments to the unit until the engine is **off** and the spark plug wire is disconnected.
- If carburetor adjustment is necessary, stand to one side and **keep feet and hands** in the clear while making adjustments.
- Keep engine free of accumulations of grass, leaves or excessive grease. An accumulation of these combustible materials may result in a fire.
- Store gasoline in a **safe and approved** container in a cool, dry place.
- Keep the unit and any fuel containers in locked storage to prevent children from playing and/or tampering with them.
- Do not store gasoline powered equipment or fuel containers in a basement or any closed area where heating or heat appliances or open pilot lights are present, unless the fuel is completely drained from the power equipment and the fuel containers.

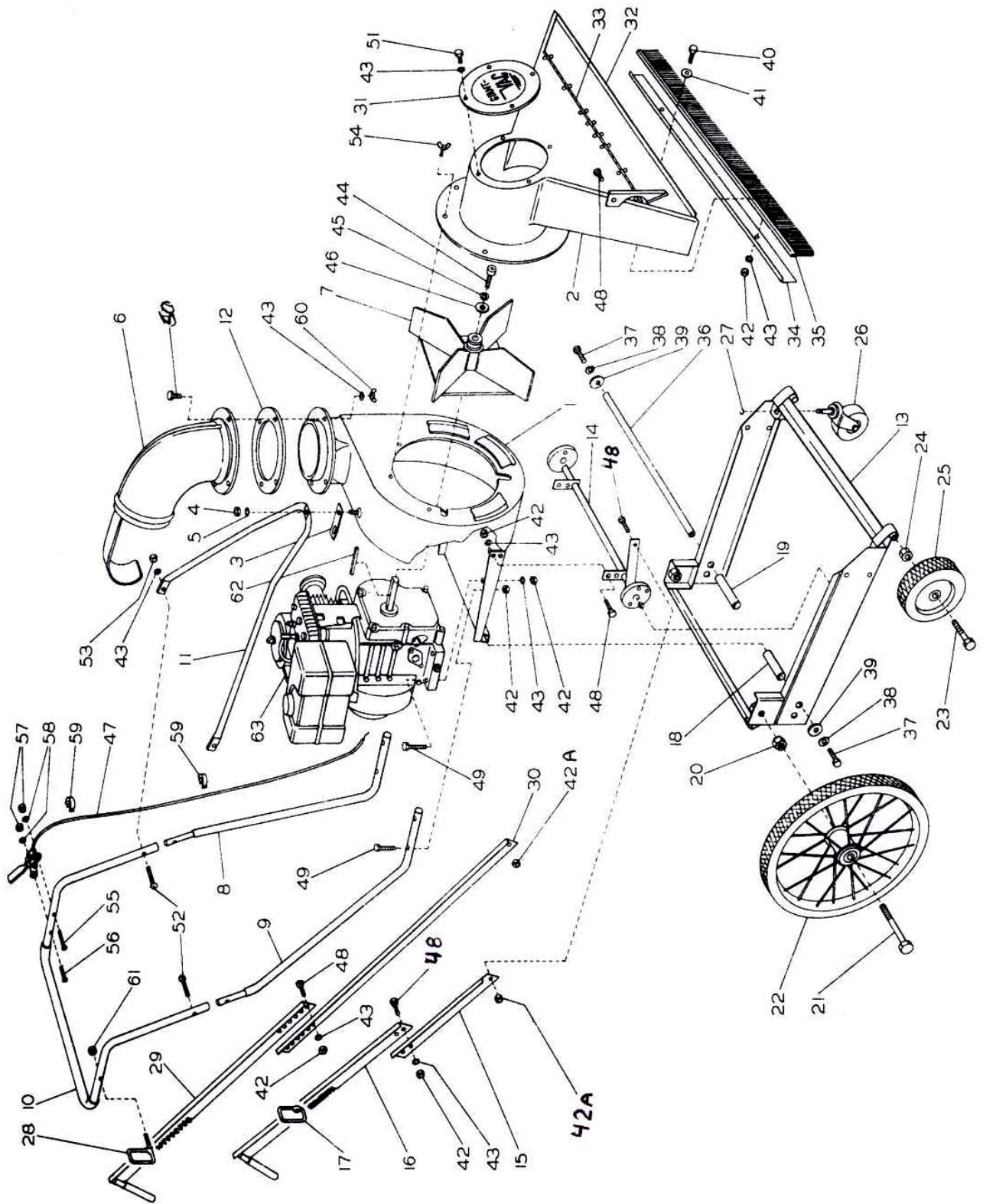

PARTS LIST NO. 5803

<u>REF.</u> <u>NO.</u>	<u>PART</u> <u>NO.</u>	<u>DESCRIPTION</u>	<u>954</u>	<u>956</u>
1	10235	Blower housing & engine base	1	1
2	27059	30F nose cone body	1	1
2	27061	36F nose cone body	1	1
2-A	27058	30C nose cone body	1	1
2-A	27060	36C nose cone body	1	1
3	31591	Anti-vibration bracket	1	1
4	31009	3/8" hex nut	1	1
5	31115	3/8" lock washer	1	1
6	24510	Exhaust elbow	1	1
7	21558	Impeller (complete w/Taper-Lok hub)	1	1
8	23013	Lower handle left	1	1
9	23010	Lower handle right	1	1
10	23009	Upper handle	1	1
10a	31590	Foam handle cover	1	1
11	23011	Handle brace	1	1
12	31105	Rubber gasket	1	1
13	27055	Under carriage	1	1
14	27056	Lifter cam	1	1
15	23038	Lower lifter arm	1	1
16	23039	Upper lifter arm	1	1
16a	31283	Handle grip	1	1
17	31111	Lifter arm "U" clip	1	1
18	33152	Spacer back wheel - right	1	1
19	33043	Spacer back wheel - left	1	1
20	31110	3/4" hex nut	2	2
21	31109	3/4 x 5" hex bolt	2	2
22	33041	Back wheel 20"	2	2
23	31461	1/2-13 x 2-1/2" hex bolt	--	2
24	31022	1/2-13 hex nut	--	2
25	33010	8 x 1.75 wheel	--	2
26	33009	4" caster wheel – plain stem	2	--
27	----	Snap clip – comes with 4" caster	2	--
28	31102	"U" type holder	1	1
29	23040	Upper adjuster bar	1	1
29a	31283	Handle grip	1	1
30	23041	Lower adjuster bar	1	1
31	27064	Cover plate	1	1
32	27062	Door for 30F	1	1
32	27063	Door for 36F	1	1
33	27043	Hinge for 30F	1	1
33	27044	Hinge for 36F	1	1
34	27019	Brush holder 30"	1	1
34	27020	Brush holder 36"	1	1
35	27010	30" brush	1	1
35	27011	36" brush	1	1

PARTS LIST NO. 5803

<u>REF.</u> <u>NO.</u>	<u>PART</u> <u>NO.</u>	<u>DESCRIPTION</u>	<u>954</u>	<u>956</u>
36	33045	22" lift pivot axle	1	1
37	31044	1/2 x 1 hex bolt	2	2
38	31078	1/2" lock washer	2	2
39	31119	1/2" flat washer	2	2
40	31005	5/16 x 1 1/4" hex bolt	2	2
41	31145	5/16" flat washer	2	2
42	31004	5/16" hex nut	18	18
42a	31436	5/16" lock nut	2	2
43	31003	5/16" lock washer	24	24
44	31646	5/16-18 x 1-1/4 hex bolt Gr 5	3	3
45	31003	5/16" lock washer	3	3
46	21559	Taper-Lok hub – 1-1/8"	1	1
47	35002	Throttle control	1	1
48	31031	5/16 x 3/4" hex bolt	8	8
49	31002	5/16 x 1 3/4" hex bolt	8	8
49a	31027	5/16 flat washer (engine base)	1	1
50	31032	5/16 x 1 hex bolt	4	4
51	31016	5/16 x 5/8" hex bolt	4	4
52	31056	5/16 x 1 1/2" round head bolt	2	2
53	31028	5/16 acorn nut	2	2
54	31026	3/8-16 wing bolt	3	3
54a	31008	3/8" lock washer	3	3
55-58	31010	10-24 x 1 1/4" bolt/washer/nut group	2	2
59	31007	Throttle clip	2	2
60	31592	5/16" wing nut	4	4
61	31098	1/4" lock nut	1	1
62	31795	1/4 x 2-1/8" impeller key	1	1
63	39094	9 HP B&S Intek engine	1	1

PARTS LIST NO. 5803

<u>REF.</u> <u>NO.</u>	<u>PART</u> <u>NO.</u>	<u>DESCRIPTION</u>	<u>954</u>	<u>956</u>
<u>ITEMS NOT SHOWN</u>				
	24533	Blower air chute	1	1
	20101	Blower intake baffle	1	1
	24513	Blower chute deflector	1	1
	31055	1/4 x 5/8" bolt, wing nut & lock washer	2	2
	20151	DF1 hose holder 4"	1	1
	20152	DF1 hose holder 5"	1	1
	20153	DF1 hose holder 6"	1	1
	34002	Intake hose 4"	1	1
	34003	Intake hose 5"	1	1
	34004	Intake hose 6"	1	1
	34006	Intake hose 8"	1	1
	34018	Exhaust hose 7" x 10' metal	1	1
	34011	Hose clamp 4"	2	2
	34012	Hose clamp 5"	2	2
	34013	Hose clamp 6"	2	2
	34015	Hose clamp 8"	2	2
	34047	Squeeze ring 7"	1	1
	20145	Nozzle 4"	1	1
	20146	Nozzle 5"	1	1
	20147	Nozzle 6"	1	1
	20149	Nozzle 8"	1	1
	20106	Intake flange 4"	1	1
	20107	Intake flange 5"	1	1
	20108	Intake flange 6"	1	1
	20115	Intake flange 8"	1	1
	24511	Exhaust flange 7"	1	1
	210	Dust control bag	1	1
	510	Liner bag	1	1
	710	Polypropylene bag	1	1

SPECIFICATIONS SUBJECT TO CHANGE WITHOUT NOTICE

GIANT-VAC WARRANTY

GIANT-VAC, INC., here-in-after called Giant-Vac, warrants each new Giant-Vac to the original retail purchaser of the new Giant-Vac equipment to be free from manufacturing defects in normal service for a period of 1 year, unless it is used for rental purposes, which limits the warranty to 30 days. This warranty does not apply to engines, tires or other parts that are purchased and warranted by their manufacturer. Items such as bags, grass catchers, hoses and blades are not warranted, as these are considered expendable items. This warranty does not include equipment failures due to normal wear.

Any obligation under this warranty is expressly limited to the replacement or repair, at an authorized servicing Giant-Vac dealer, or at a point designated by us, of such parts as appear to us to have been defective. All defective parts have to be returned freight prepaid before credit will be issued.

We shall not be liable for transportation charges in connection with the replacement or repair of defective parts.

This warranty does not apply to a Giant-Vac upon which repairs or alterations have been made by others except with our prior written approval.

We shall not be liable for consequential damages or contingent liabilities for the fitness of any Giant-Vac for any particular purpose.

We make no other express, implied or statutory warranty, nor is anyone authorized to make any in our behalf.

**GIANT-VAC, INC.
P.O. BOX 195
SOUTH WINDHAM, CT. 06266
PHONE: 860-423-7741 • FAX: 860-423-2654**
