

OPERATING INSTRUCTIONS FOR MODEL 555 GIANT TRAIL VAC

As you unpack your Giant Trail Vac, you will find it consists of three separate cartons:

- 1 - Power unit with motor, impeller and throttle cable mounted, trailer wheels, hardware, front trailer hitch and dust bag.
- 2 - Trailer body, trailer axle, bag support handle and exhaust elbow.
- 3 - Mower pan chute, tractor rear hitch, flexible hose, two 6" clamps and a 6" intake flange.

Inspect parts for any damage that might have occurred in shipping. If any is found, save the packing box and **IMMEDIATELY** notify the transport carrier who delivered your machine as he is responsible for the damage and is the only one to make any adjustments. Before leaving our plant, all components were thoroughly inspected. All manufacturing dimensions are held to close tolerances, and thus, you will have little difficulty in assembling your Giant Trail Vac, if you follow these steps.

MOTOR INSTRUCTIONS: You have received a complete engine manual with your machine. Be sure to especially note instructions on **OILING**. **FILL OUT WARRANTY CARD IMMEDIATELY** and send it to the engine manufacturer, as directed, as they are responsible for the operation of this engine and will service it. If you have any difficulties with the engine, it is best to contact the engine manufacturer, rather than us, as much time will be saved.

ASSEMBLY INSTRUCTIONS: First, take trailer body Ref. #11 and turn upside down and take trailer axle Ref. #12 and bolt axle into middle set of holes (for best balance). Install wheels Ref. #13 with washer and snap ring. Turn trailer body right side up and put bag support handle Ref. #10 on. For best results, install front hitch Ref.#7 onto power unit Ref. #1. Install exhaust elbow Ref. #2 onto power unit. Install intake flange Ref. #4 onto power unit. Put hitch Ref. #8 onto back of tractor. Install chute Ref. #9 onto tractor mower discharge side. (Chutes are custom-fitted for each tractor brand, however, in some cases, holes must be drilled in mower pan and mower exhaust guards must be removed.) Put flexible hose between Ref. #4 and Ref. #9 and fasten with hose clamps Ref. #5 and install dust control bag. **BE SURE** that unit is completely assembled and mower chute is examined for proper clearance between blades and the the engine is fully serviced.

IMPORTANT: Do not attempt to remove or adjust any part or parts of machine or tractor mower while either machine is running.

IMPORTANT: Remove spark plug before attempting to work on impeller and blower housing.

HOSE ATTACHMENT: You may install an intake hose attachment by removing suction hose and installing a 6" x 10' intake hose with nozzle onto 6" intake flange - already on power unit. This will enable you to clean around shrubs and pick up leaves that have been windrowed.

DUST CONTROL BAG: The bag is held in place over the exhaust nozzle by means of a fast tightening locking buckle. It is fastened to the back handle bar by means of four snaps. This is a large capacity bag, designed to keep dust to a minimum. A vent is added at the upper end of the zippered opening for fast pick-up on some applications. This allows the bag to be filled completely. The bag should always be emptied when a job is completed. Debris should never be left in the bag when machine is not in use. The bag should be thoroughly cleaned periodically. One way to clean the bag is to leave the zipper open and run the engine for a few minutes while shaking the bag vigorously. Turning the bag inside out and sweeping briskly with a stiff broom is sometimes desirable when the bag is extremely dirty. **TO AVOID INJURY,** do not stand behind the opening with the zipper open while the engine is running. The bag has to be kept clean for efficient operation. Four bags can be cleaned in a coin machine. **IMPORTANT:** Never wash a bag as the pores will shrink and a bag must be porous as many thousands of cubic feet of air per minute escape through these pores. If they become plugged, the operational efficiency of your machine will be greatly reduced.

WARRANTY

GIANT-VAC MFG. COMPANY INCORPORATED, here-in-after called Giant-Vac, warrants each new Giant-Vac to the original retail purchaser of new Giant-Vac equipment to be free from manufacturing defects in normal service for a period of 90 days, unless it is used for rental purposes which limits the warranty to 30 days. This warranty does not apply to engine, tires, or other parts that are manufactured and warranted by the manufacturer. Items such as bags, grass catchers, hoses and blades are not warranted - as these are considered expendable items. This warranty does not include equipment failures due to normal wear.

An obligation under this warranty is expressly limited to the replacement or repair at an authorized servicing Giant-Vac dealer, or at a point designated by us, of such part or parts as shall appear to us to have been defective. All defective parts have to be returned freight prepaid before credit is issued.

We shall not be liable for transportation charges in connection with the replacement or repair of defective parts.

This warranty does not apply to a Giant-Vac upon which repairs or alterations have been made by other except with our prior written approval.

We shall not be liable for consequential damages or contingent liabilities nor for the fitness of any Giant-Vac for any particular purpose.

We make no other express, implied or statutory warranty nor is anyone authorized to make any in our behalf.

MODEL 555
GIANT-TRAIL VAC

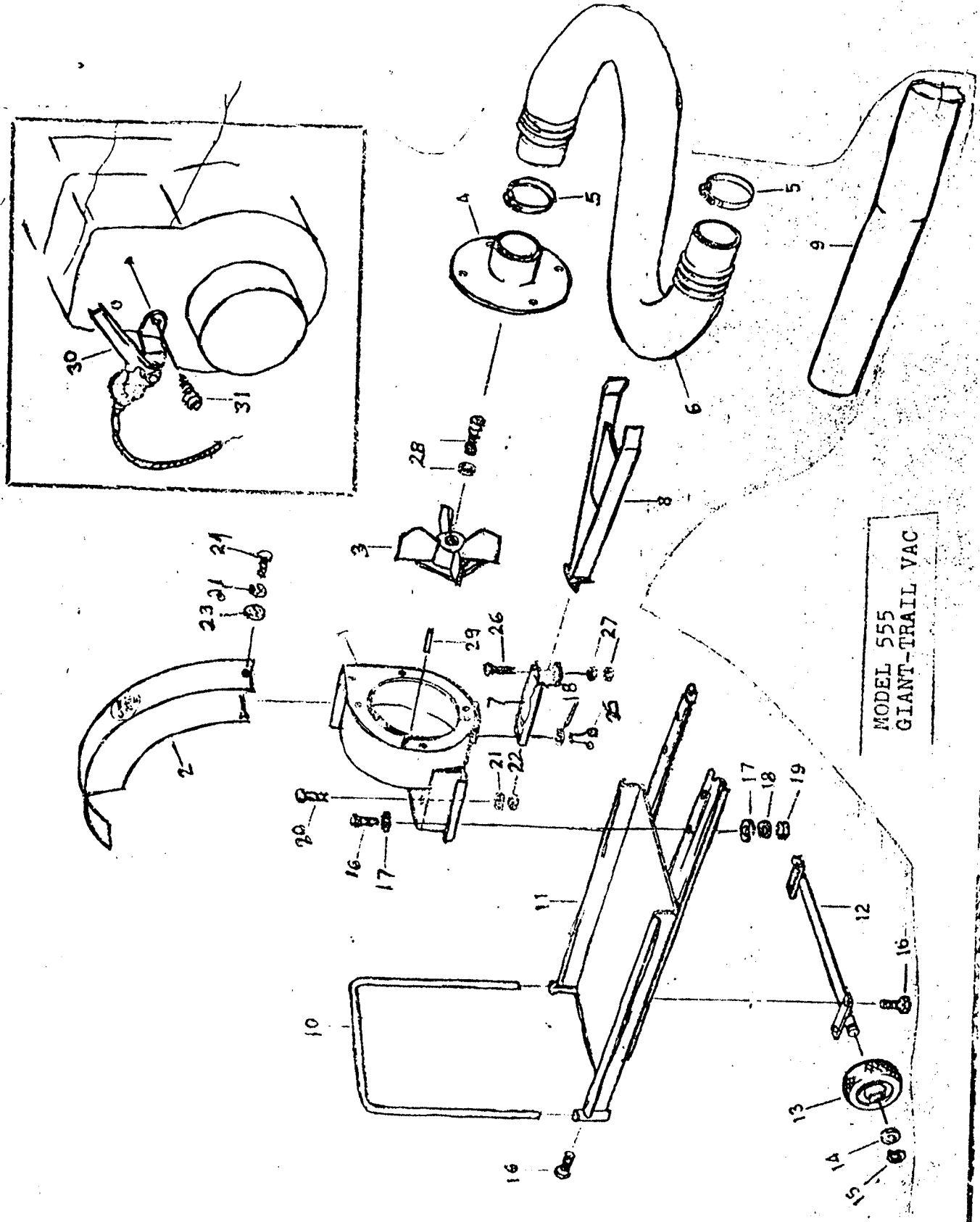

REFERENCE NO.	PART NO.	DESCRIPTION	MODEL 555
1	10021	Blower and engine base	1
2	24506	Exhaust elbow	1
3	21501	Impeller 1" shaft	1
4	20108	Intake flange 6"	1
5	34013	Hose clamps 6"	2
6	34046	Intake hose 6" x 6'	1
7	38001	Front trailer hitch	1
9	27146	Mower chute - R.H. discharge	
9	27147	Mower chute - L.H. discharge	
10	23007	Rear trailer bag support	1
11	27003	Trailer body	1
12	33012	Trailer axle	1
13	33001	Wheel 410 x 3.50 pneu.	2
14	31001	Flat washer 5/8"	2
15	31000	Snap ring 5/8"	2
16	31033	Bolt 3/8" hex cap 3/8 x 1"	10
17	31034	Flat washers 3/8"	12
18	31008	Lock washers 3/8"	16
19	31009	Nuts 3/8"	8
20	31006	Hex bolt 5/16" x 1-1/2"	4
21	31003	Lock washers 5/16"	11
22	31004	Nuts 5/16"	4
23	31027	Flat washers 5/16"	3
24	31017	Bolt hex cap 5/16" x 1/2"	7
25	31035	Bolt hex cap 3/8" x 5/8"	4
26	31021	Bolt hex cap 1/2" x 4-1/2"	1
27	31012	Jam nut 1/2"	2
28	31019	Impeller bolt and key 3/8 -24-2	1
30	35000	Throttle control	1
31	31036	Screw 10 x 1/2"	2
	115	Dust control bag	1
	39001	5HP B&S engine	1