

OPERATING INSTRUCTIONS
FOR
GIANT-TRAIL-VAC
MODELS 1895 AND 3095.

Your Giant-Trail-Vac comes complete in one crate with the necessary parts with the exception of the Hose Kit which comes in a separate box.

Inspect your unit for any damage that might have occurred in shipping. If any is found, save the packing container and IMMEDIATELY notify the transport carrier who delivered your machine as he is responsible for the damage and is the only one to make any adjustments. Before leaving our plant, all components were completely inspected. All manufacturing dimensions are held to close tolerances, and thus, you will have little difficulty in assembling your Giant-Trail-Vac if you follow these steps.

MOTOR INSTRUCTIONS: You have received a complete engine manual with your machine. Especially note instructions on OILING. Fill out the WARRANTY CARD IMMEDIATELY and send it to the engine manufacturer as directed. Engines are warranted by the engine manufacturer and not by Giant-Vac. Consequently, if any difficulties exist, please contact them rather than us as much time will be saved as they would be the only ones to make any adjustments. If you will check the yellow pages in your telephone directory, you will find the local engine servicing dealer.

CAUTION
ROTATING FAN

**BEFORE MAKING ANY ADJUSTMENTS OR REPAIRS
STOP ENGINE AND REMOVE SPARK PLUG WIRE.
WHILE IN OPERATION KEEP ALL PARTS OF BODY
AWAY FROM INTAKE AND EXHAUST SECTIONS.**

ASSEMBLING: Your Models 1895 and 3095 Trail Vac's are shipped completely assembled. IMPORTANT: Engine is shipped without oil. Follow the engine manufacturers recommendations for oil and fuel - recommendations and service. This should be read carefully to ensure maximum engine life.

ASSEMBLING THE OPTIONAL INTAKE HOSE KIT; Attach the intake flange to the front on the nose cone with four 3/8" x 3/4" bolts and lockwashers. Attach the intake hose onto the intake flange with one hose clamp. Then attach the intake nozzle with clamp to outer end of the intake hose.

TRAILER-DUMPING: Your Giant-Trail-Vac has a 5 cubic yard trailer. The trailer will self-dump. When trailer is full, back trailer to the dumping yard. Take back door holder arm Ref. #9 and unlatch bracket and lift up back door and the debris will come out.

GREASE THE TRAILER WHEELS EVERY EIGHT HOURS OF OPERATING THE UNIT.
ALL PRICES AND SPECIFICATIONS SUBJECT TO CHANGE WITHOUT NOTICE.

JULY 13, 1990

NOSE CONE: The nose cone is mounted on the power unit and has two rubber flaps. It can be easily raised or lowered by loosening two bolts and sliding the flap by means of the adjustable slots provided. The height of the flaps depends upon the particular application. In essence, the back flap should be touching the surface.

HOSE ATTACHMENT KIT: This hose kit contains an 8" x 10' hose, intake flange and nozzle with clamps. The flange connects to the front of the nose cone. The nose cone contains a shut-off flap. With this, all of the air is directed through the hose when in operation. Convenient hose carrying brackets are also supplied.

GIANT-VAC WARRANTY

GIANT-VAC MFG. COMPANY INCORPORATED, here-in-after called Giant-Vac, warrants each new Giant-Vac to the original retail purchaser of new Giant-Vac equipment to be free from manufacturing defects in normal service for a period of 90 days, unless it is used for rental purposes which limits the warranty to 30 days. This warranty does not apply to engines, tires or other parts that are manufactured and warranted by the manufacturer. Items such as bags, grass catchers, hoses and blades are not warranted, as these are considered expendable items. This warranty does not include equipment failures due to normal wear.

An obligation under this warranty is expressly limited to the replacement or repair at an authorized servicing Giant-Vac dealer, or at a point designated by us, of such parts or parts as such appear to us to have been defective. All defective parts have to be returned freight prepaid before credit is issued.

We shall not be liable for transportation charges in connection with the replacement or repair of defective parts.

This warranty does not apply to a Giant-Vac upon which repairs or alterations have been made by others except with our prior written approval.

We shall not be liable for consequential damages or contingent liabilities more for the fitness of any Giant-Vac for any particular purpose.

We make no other express, implied or statutory warranty, nor is anyone authorized to make any in our behalf.

ALL PRICES AND SPECIFICATIONS SUBJECT TO CHANGE WITHOUT NOTICE. JULY 13, 1990

SAFETY AND OPERATING INSTRUCTIONS
FOR GIANT-VAC TRAIL VACS

CAUTION
ROTATING PARTS

1. BEFORE OPERATING - READ OPERATORS MANUAL FOR OPERATING AND SAFETY INSTRUCTIONS.
2. DO NOT OPERATE WITH ANY GUARDS OR COMPONENT PARTS REMOVED FROM UNIT.
3. BEFORE MAKING ANY ADJUSTMENTS OR REPAIRS, STOP ENGINE AND REMOVE SPARK PLUG WIRES ON GAS ENGINES - ON DIESEL ENGINE BE SURE ENGINE KILL SWITCH IS ACTIVATED.
4. WHILE IN OPERATION KEEP ALL PARTS OF BODY AWAY FROM INTAKE AND EXHAUST SECTIONS.
5. WHEN OPERATING MACHINE KEEP PEOPLE AND PETS A SAFE DISTANCE AWAY.

TRAINING:

1. Regard your Giant-Vac Leaf Vacuum as a piece of power equipment and teach this regard to all who operate this unit.
2. Never allow children or young teen-agers to operate the Giant-Vac Leaf Vacuum..
3. Be sure you know how to stop the engine at a **MOMENT'S NOTICE**.
4. Instruct children to keep away from the area of operation at all times.

PREPARATION:

1. Before starting operation, clear the entire work area of all debris that could catch on or be thrown by the Giant-Vac Leaf Vacuum.
2. Unless there is very good artificial light, use only during the daylight hours.
3. Fill the Giant-Vac Leaf Vacuum fuel tank outdoors. Avoid spilling fuel and do not fill the tank while engine is running or while you are smoking.

OPERATION:

- 1 Do not operate with any guards or component parts removed from unit.
2. Before making any adjustments or repairs, stop engine and remove the spark plug wire on gas engine - on diesel engines be sure engine kill switch is activated.
3. Whil in operation, keep all parts of body away from intake and exhaust sections.
4. When operating machine, keep people and pets a safe distance away.
5. Follow the engine manufacturer's recommendations for safe operation.
6. Use caution in selecting your cleaning pattern.
7. Never allow another person to ride or stand on the Giant-Vac Leaf Vacuum. NEVER allow another person to ride on the towing vehicle.
8. If the leaves are dry - in most cases we recommend running at approximately half throttle. This will help reduce small particles of debris from escaping through the exhaust screen. When the leaves are wet or partially frozen, we recommend running the machine at full throttle.
9. Never use your Giant-Vac Trail Vacuum to pick up sand or stones. Debris like this is very abrasive and can damage the impeller and blower housing.

PARTS LIST #5740

MODELS 1895 AND 3095

REF. NO.	PART NO.	DESCRIPTION	1895	3095
1	27071	Trailer body	1	1
2	37019	Door holder bracket	2	2
3	37022	Door and spring bracket - Left	1	1
3-a	37023	Door and spring bracket - Right	1	1
4	37020	Door bracket stand off	2	2
5	37021	Door bracket stand off	2	2
6	37008	Door spring	2	2
7	37016	Door handle	1	1
8	27072	Back door	1	1
9	37024	Door holder bracket	1	1
10	37025	Holder bracket	1	1
11	24550	Exhaust stack flange	1	
11	24604	Exhaust stack flange		1
12	27073	Trailer brace - Left	1	1
13	27074	Trailer brace - Right	1	1
14	27213	Rear axle holder	1	
14	27214	Rear axle holder		1
15	27215	Front axle holder	1	
15	27216	Front axle holder		1
16	33145	Trailer axle	1	
16	33146	Trailer axle		1
17	31150	Polypropylene lower screen	1	1
18	33054	18 x 850 x 8 back tire & rim	2	
18	33144	23 x 10.50 x 12 Back tire & rim		2
19	33055	Dust cap	2	2
20	31151	Lock nut and set screw	2	2
21	33056	Bearing - high speed	4	4
22	33057	Seal	4	4
23	33058	Hub less bearing	2	
23	33149	Hub less bearing		2
24	31152	Lug nut	8	10
25	33059	16 x 650 x 8 front tire & rim	2	2
26	33060	Front axle	2	2
27	33061	Caster horn and stud	2	2
28	33062	Wheel spacers	4	4
29	10131	Motor base	1	
29	10132	Motor base		1
30	20163	Nozzle 8"	1	
30	20150	Nozzle 10"		1
31	20164	Intake flange 8"	1	
31	20192	Intake flange 10"		1
32	21517	Impeller	1	
32	21518	Impeller		1
33	24551	Exhaust stack	1	
33	24604	Exhaust stack		1
34	27077	Wheel leg - Right	1	
34	27227	Wheel leg - Right		1

PARTS LIST #5740

MODELS 1895 AND 3095

REF. NO.	PART NO.	DESCRIPTION	1895	3095
34-a	27078	Wheel leg - Left	1	
34-a	27228	Wheel leg - Left		1
35	33147	Axle shaft	1	
35	33148	Axle shaft		1
36	27080	Nose cone body	1	
36	27217	Nose cone body		1
37	27081	Rubber flap holder	2	
37	27218	Rubber flap holder		2
38	27082	Rubber flap outer clamp	2	
38	27219	Rubber flap outer clamp		2
39	27083	Rubber flap	2	
39	27220	Rubber flap		2
40	34006	Hose 8" x 10'	1	
40	34007	Hose 10" x 10'		1
41	34015	Hose clamp 8"	2	
41	34016	Hose clamp 10"		2
42	10130	Blower housing	1	
42	10041	Blower housing		1
43	38008	Hitch	1	
43	38025	Hitch		1
44	40113	Gas tank	1	
45	40114	Gas tank cap	1	
46	31153	Gas tank holer	2	
47	20165	Nozzle 8"	1	
48	31155	Rubber handle 7/8"	1	1
49	33063	Spacer set for caster horn	2	2
50	31154	Impeller bolt & key	1	
51	31156	Bolt, nut & lockwasher 3/8 x 1"	12	12
52	31157	Bolt, nut & lockwasher 1/2" x 4-1/2"	4	4
53	31158	Bolt & washer 1/2" x 1-1/4"	8	8
54	31092	Bolt & locknut 7/8" x 3"	2	2
55	31159	Nut & lockwasher 1/2"	12	12
56	31162	Bolt, nut & lockwasher 1/2"	12	12
57	31161	Bolt & locknut 1/2" x 3"	8	8
58	31160	Bolt, nut & washer 5/16" x 1-1/2"	6	6
59	31566	Bushing 1-1/4"	4	4
60	27221	Rubber side flap	2	
60	27222	Rubber side flap		2
61	27223	Rubber side holder	2	
61	27224	Rubber side holder		2
62	27225	Rubber side clamp	2	
62	27226	Rubber side clamp		2
	39019	23HP Kohler engine	1	
	39022	30HP Wisconsin engine		1

ALL PRICES AND SPECIFICATIONS SUBJECT TO CHANGE WITHOUT NOTICE.

MODEL 1895 AND 3095 TRAIL-VAC
POWER UNIT SECTION

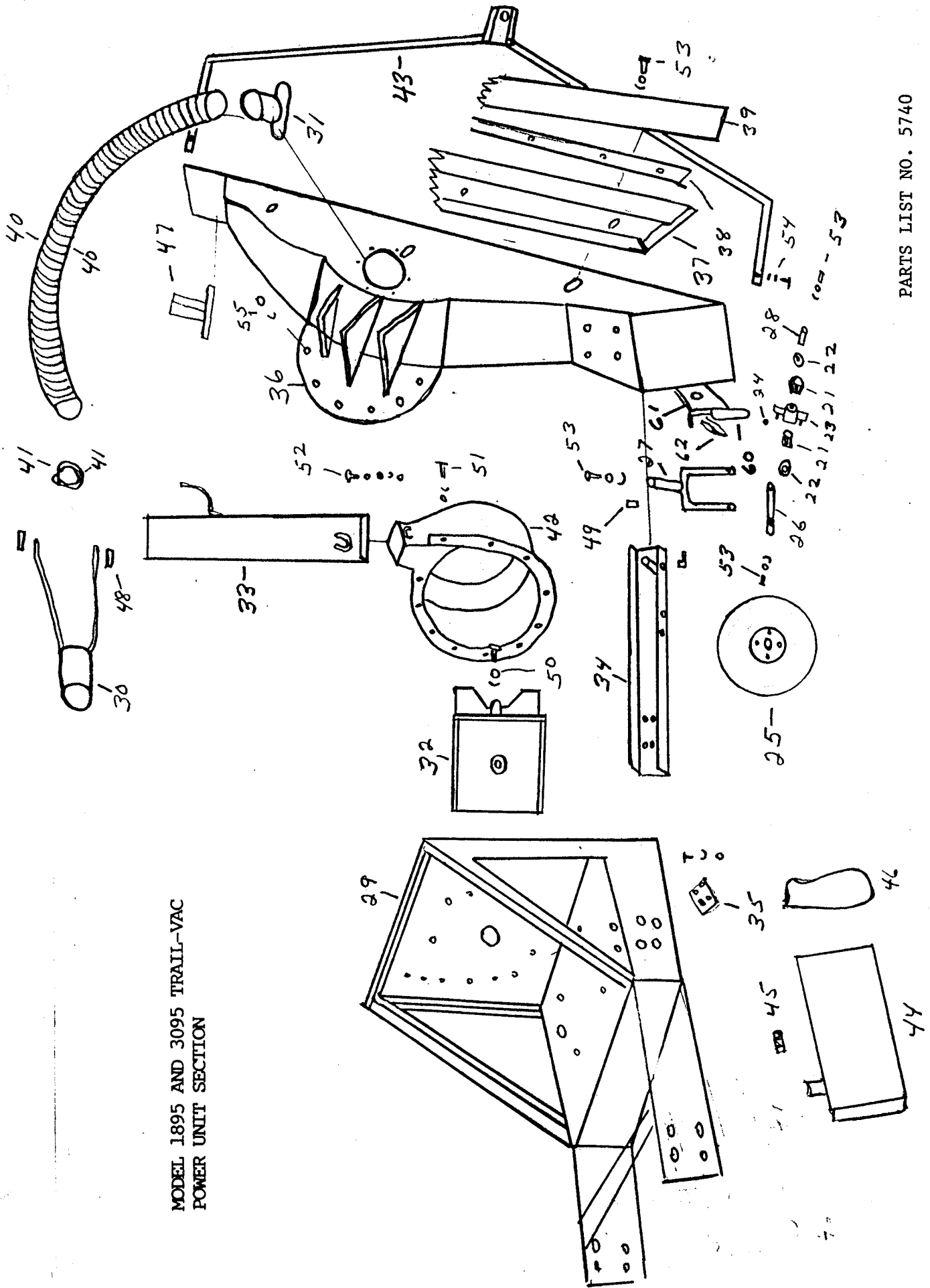

PARTS LIST NO. 5740

ODEL 1895 AND 3095 trail-VAC
TRAILER SECTION

